

대한흉부심장혈관외과학회 제49차 추계학술대회

일시: 2017년 11월 5일(일)~8일(수)

장소: 롯데 호텔 제주 연회동 6층

대한흉부심장혈관외과학회

인 사 말

존경하는 대한흉부심장혈관외과학회 여러분!

안녕하십니까?

유난히 무덥고 찌는 더위 속에서 어떻게 지내시는지요?

언제나 어려운 조건 속에서도 묵묵히 진료와 연구 및 교육에 매진하시는 회원 여러분들께 한없는 박수를 보냅니다.



학회가 당면한 여러 문제점에 대한 해결 방안을 모색하는 노력은 계속하고 있습니다만,

새로운 정권 이 후 약간의 숨 고르기를 하고 있는 양상입니다. 새 체제가 자리 잡는 대로 여러 분야 별로 슬기롭게 대처해 나갈 예정입니다.

제49차 추계학술대회는 대한흉부외과 학회 50주년을 앞두고, 15년만에 제주도에서 개최됩니다.

예년과 같이 훌륭한 프로그램이 마련되어 있으며, 많은 시상도 준비되어 있습니다.

뜨거운 여름을 거치며 그 동안 진료한 결과 및 연구한 성과들을 발표하고 서로 공유하며 토론하는 장소가 되었으면 합니다.

후학들의 교육을 위한 본보기의 장소가 되었으면 합니다.

각 대학 및 연구실간의 상호 교류 및 학회 회원들 간의 친목 유대의 장소가 되었으면 합니다.

부디 회원 여러분들이 적극적으로 참여하시어 그 동안의 진료, 연구 및 교육에 지친 모두에게 재충전하는 가을의 훌륭한 축제가 되었으면 합니다.

2017년 8월

대한흉부심장혈관외과학회 회장 **조재일**

A handwritten signature in black ink, appearing to read '조재일' (Jo Jae-il). The signature is written in a fluid, cursive style.

대한흉부심장혈관외과학회 임원명단

2016년 10월 ~ 2017년 10월

회 장 조재일

부 회 장 김범식, 김응중, 박국양, 박영환, 이정철

이 사 장 심성보

차기이사장 오탈운

상 임 이 사 강경훈, 김동관, 김성철, 나찬영, 백완기, 백효채, 오탈운, 유재현, 이정상, 홍종면

이 사

강경훈, 강정한, 강창현, 강청희, 김경화, 김관민, 김관창, 김근직, 김대현, 김동관, 김성철, 김수철, 김영대, 김영태, 김용환, 김재현, 김정철, 김정택, 김종우, 김종인, 김진국, 김한용, 김현조, 김 혁, 나국주, 나찬영, 류한영, 문동석, 문병주, 문석환, 문현중, 박계현, 박남희, 박종빈, 박철현, 박한기, 백만중, 백완기, 백효채, 백희중, 손호성, 송 현, 신운철, 신재승, 신화균, 오상기, 오탈운, 유경중, 유재욱, 유재현, 윤정섭, 이기중, 이상권, 이석기, 이석열, 이석재, 이성수, 이성호, 이양행, 이원용, 이장훈, 이재익, 이정상, 이종목, 이창하, 이해원, 이현석, 이 건, 이 섭, 임상현, 장지원, 전태국, 전희재, 정성운, 정인석, 정종필, 정철현, 제형곤, 조광리, 조광조, 조덕곤, 조성준, 조준용, 주석중, 지현근, 최진호, 최창휴, 허 진, 홍종면, 홍준화, 황재준

총 무 이 사 서중희

감 사 신성호, 윤희철, 허동명

- 기획홍보위원회** 전태국(장), 강창희, 김대준, 김도형, 김수성, 김수철, 김환옥, 류한영, 손호성, 신성호, 이동협, 이석열, 이석재, 임 청, 정진용, 조양현
- 간행위원회** 백희중(장), 김경환, 나명훈, 박기성, 박한기, 백만중, 서필원, 송석원, 윤태진, 이 삭, 이성호, 조광조, 최시영, 최용수, 홍기표, 홍종면, 황재준, Dr.Alec Patterson, Dr.Arata Murakami, Dr.Byung C. Moon, Dr.Francis D. Ferdinand, Dr.Hendrick B. Barner, Dr.Kemp H. Kernstine, Dr.Marcello Carlo Ambrogi, Dr.Tirone E David, Dr.Tom R. Karl
- 고시위원회** 정성운(장), 권종범, 김경환, 김도훈, 김재범, 김형렬, 김형태, 김홍관, 박인규, 박정준, 신재승, 신흥주, 양지혁, 이진구, 이충원, 임 청, 최창휴
- 교육위원회** 나국주(장), 강신광, 공준혁, 금동윤, 김관창, 김근직, 김정철, 김태식, 김형태, 박계현, 박성용, 신흥주, 이길수, 이성수, 이재항, 이 철, 장우성, 전재현, 정인석, 제형근, 조민섭, 조석기, 조정수, 최은석, 황정주, 황진옥
- 보험위원회** 문석환(장), 공준혁, 곽재건, 김시호, 김영두, 김태식, 박남희, 박성식, 박인규, 신성호, 신윤철, 오상기, 운영남, 이영옥, 이재익, 이해원, 임상현, 장형우, 정성호, 정원석, 정재승, 조민섭, 조양현, 조창욱, 조현민, 홍순창
- 심사위원회** 유경중(장), 강두영, 김동원, 김영대, 김재현, 김준석, 류경민, 운영남, 윤유상, 윤효철, 이석재, 이응배, 장지원, 최진호
- 재정위원회** 윤정섭(장), 강정한, 김경화, 배지훈, 박철현, 이기종, 이석기, 전현우, 조광조, 조종호, 최재성, 홍종면
- 학술위원회** 김관민(장), 강민웅, 강창현, 김정철, 김웅한, 김재범, 김현구, 김홍관, 박한기, 성기익, 양지혁, 이 삭, 이창하, 정재승, 조덕곤, 주석중, 지현근, 최세훈, 최재성, 함석진, 황호영
- 국제교류회** 김영태(장), 김옥성, 김준범, 배미경, 성용원, 정인석
- 정보위원회** 최창휴(장), 강준규, 염상윤, 오세진, 이석기, 이송암, 이해영, 정재승, 조원민, 허 균
- 정책윤리위원회** 신재승(장), 곽영태, 권오춘, 김동원, 김요한, 김 혁, 나찬영, 문병주, 박승일, 박영환, 서종희, 성시찬, 오상준, 오태윤, 유경중, 윤정섭, 윤치순, 정성운, 정태은, 조덕곤, 홍종면
- 역사기록보존위원회** 박국양(장), 곽재건, 김근직, 김상형, 신재승, 심성보, 오상기, 이성수, 장병철, 정한나, 조덕곤

참가 특별회원명단

제49차 추계학술대회

부스위치	업체명	부스위치	업체명
15	나우메드(유)	24	남북써지칼(주)
3, 4	(주)녹십자	1	(주)다림양행
51, 52	동화약품(주)	25, 26	라파메드(유)
12	(주)마퀘트메디칼코리아	31~34	메드트로닉 코리아 유한회사
7	(주)메손	48	멘리케헬스케어코리아
41, 42	미쓰비시다나베파마코리아	46, 47	(주)박스터
6	성우메디텍 주식회사	16, 17	세인트쥬드메디칼코리아 유한회사
44	스미스앤드네퓨(주)	22, 23	에드워즈라이프사이언스스코리아(주)
8	에이스코리아	38	올림푸스한국한국(주)
18	인튜이티브서지컬코리아(유)	35	(주)제니스팜
36	(주)제일메디칼코퍼레이션	53	주식회사 씨에이치케이
11	주식회사 엠디아메디칼	30	(주)지상아이엔씨
43	지이헬스케어코리아 주식회사	2	짐머바이오메트코리아
5	(주)크리스탈옵틱	27	피셔앤파이크헬스케어아시아리미티드
45	(주)필립스코리아	37	(주)하주
9, 10	한국쓰리엠(주)	39, 40	한국에보트(주)
21	한국의약품물류(주)	19, 20	한국존슨앤드존슨메디칼(주)
28, 29	한국테루모주식회사	50	한림제약
13, 14	(주)한솔카디아케어	49	현대약품(주)
광고	(주)태웅메디칼	광고	에스케이케미칼(주)
광고	한국아스텔라스제약주식회사		

전시도면

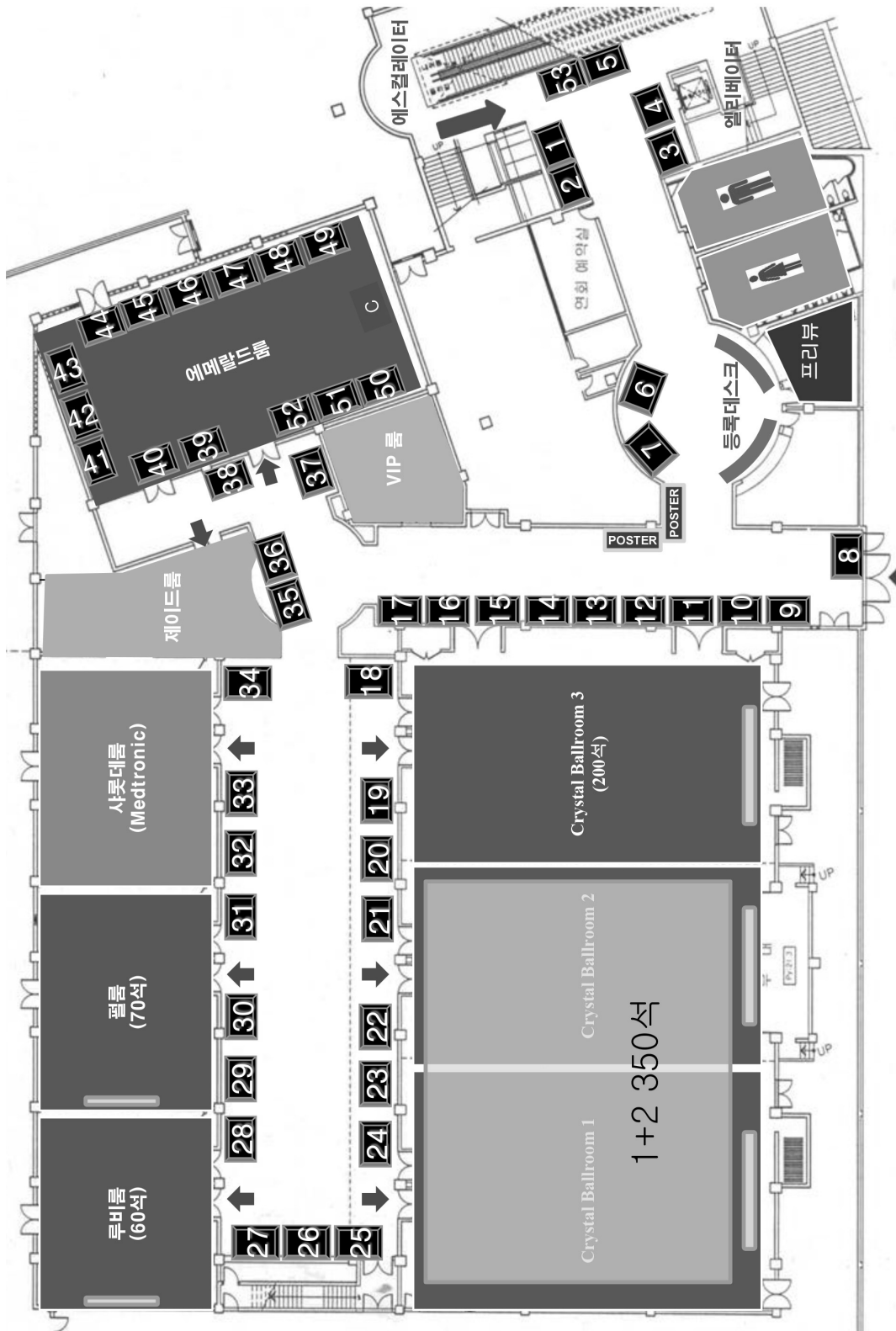

학술대회 일정표

제 1 일

2017년 11월 5일(일)
롯데 호텔 제주 연회동 6층

2017. 11. 5(일)	사파이어룸 (호텔 본관 6층)	크리스탈 볼룸 (연회동 6층)
17:00~18:00	이사회	
18:00~19:00		Welcome Reception

제 2 일

2017년 11월 6일(월)
롯데 호텔 제주 연회동 6층

2017. 11. 6(월)	크리스탈 볼룸 1+2 성인심장	크리스탈 볼룸 3 일반흉부	펠름 소아심장	샤롯데룸	루비룸	제이드룸
08:00 ~ 09:00	판막, 부정맥 I (1 ~ 5 연제) 좌장: 김경환, 문병주	일반흉부 I (18 ~ 22 연제) 좌장: 백희중, 이웅배	선천성심장질환 I (28 ~ 31 연제) 좌장: 김용진, 전태국	메드트로닉 러닝센터		
09:00 ~ 09:30	Coffee Break					
09:30 ~ 11:00	자유연제 (6 ~ 12 연제) 좌장: 전상훈, 유경중					
11:00 ~ 12:00	개회식 및 시상 · 개회식 및 축하 · 학술상 시상 - Dr. Lillehei Merit Award - Ethicon Medical Award - 일등 학술상					
12:00 ~ 13:00	Luncheon Seminar 1 좌장: 이재원(울산대학교 서울아산병원)	Luncheon Seminar 2 좌장: 임 청 (분당서울대학교병원)	Luncheon Seminar 3 좌장: 최학수 (Harvard Medical School), 이호석(부산대학교병원)			
	<메드트로닉코리아>	<한국존슨앤드존슨메디칼>	<인튜이티브 서지컬>			
	1. Permanent Pacemaker Implantation 장진근(제주한라병원 심장내과) 2. Update on Endovascular Treatment of Chronic Type IIIb Aortic Dissection 송석원(연세대학교 강남세브란스병원) 3. Surgical Modifications of Combined Maze Procedure: How I do It 이재원(울산대학교 서울아산병원)	Use of Harmonic Scalpel in Harvesting of Conduit 강준규 (가톨릭대학교 서울성모병원)	Fluorescent Image-Guided da Vinci Thoracic Surgery Using Firefly and Endowrist Stapler 김현구 (고려대학교 구로병원)			
13:00 ~ 14:00	특 강 1 좌장: 오태윤 Invisible NIR Fluorescence for Image-Guided Surgery Hak Soo Choi, PhD (Department of Radiology, Harvard Medical School)					
14:00 ~ 14:30	Medtronic 연구공로상 강연 및 시상 좌장: 심성보 이재원(울산대학교 서울아산병원)					
14:30 ~ 15:00	회장강연 및 시상 좌장: 심성보 회장: 조재일(성균관대학교 삼성서울병원)					
15:00 ~ 15:30	Coffee Break					
15:30 ~ 16:30	English Competition Forum I (1 ~ 8 연제) 좌장: 이 석, 황호영	English Competition Forum II (9 ~ 16 연제) 좌장: 함석진, 강만웅	English Competition Forum III (17 ~ 22 연제) 좌장: 유재현, 이 철			
16:30 ~ 17:30	대동맥 I (13 ~ 17 연제) 좌장: 박계현, 조광조	폐암 I (23 ~ 27 연제) 좌장: 조재일, 김영태	선천성심장질환 II (32 ~ 35 연제) 좌장: 성시찬, 이창하			
	E-poster Presentation (1 ~ 46 연제) (2017.11.6 ~ 8.)					

10:00 ~ 17:00
초음파
연수강좌
Hands-on

13:00 ~ 17:35
초음파
연수강좌

제 3 일

2017년 11월 7일(화)
롯데 호텔 제주 연회동 6층

2017. 11. 7(화)	크리스탈 볼룸 1+2 성인심장	크리스탈 볼룸 3 일반흉부	펠 룸 소아심장	샤롯데룸	사파이어룸 (호텔 6층)	루버룸
08:00 ~ 09:00	체외순환 (36 ~ 40 연제) 좌장: 이석재, 김형수	폐암 II (52 ~ 56 연제) 좌장: 김관민, 김현구	선천성심장질환 III (68 ~ 71 연제) 좌장: 박영환, 김용한	메디트론릭 러닝센터	10:00 ~ 12:00 체외순환사협회 추계학술대회	
09:00 ~ 10:00	대동맥 II (41 ~ 45 연제) 좌장: 주석중, 성기익	식도/종격동 I (57 ~ 61 연제) 좌장: 김용희, 강창현	선천성심장질환 IV (72 ~ 76 연제) 좌장: 김시호, 이정렬			09:00 ~ 10:00 지도전문의 교육
10:00 ~ 10:30	Coffee Break					
10:30 ~ 11:00	외부 초청강의 <제니스팜> 좌장: 성기익(성균관대학교 삼성서울병원) Minimally Invasive Cardiac Surgery: Do We Need Novel Cardioprotective Strategies? Prof. Garbor Balazs Szabo, MD (University of Heidelberg, Germany)					
11:00 ~ 11:30	외부 초청강의 <(주)한솔카디오키퍼> 좌장: 장병철(차의과학대학교 분당차병원) Sutureless Valves Update on Consensus Paper and Tips/Tricks to a Successful Perceval Sutureless Valve Implantation Peter J. Oberwalder, MD (Division Cardiac Surgery, Medical School Graz, Austria)					
11:30 ~ 12:30	총회 및 시상식 1. 위원장보고 2. 학술상 시상 - Medtronic Recognition Awards - 이영균 우수논문상 - 한국심장재단 우수논문상 - 흉부외과 의료 봉사상 3. 임원 인준					
12:30 ~ 13:30	Luncheon Seminar 4 좌장: 이재원(울산대학교 서울아산병원) <에드워즈라이프사이언시스 코리아> Rapid Deployment Valve: Can it Replace Conventional Tissue Valve Operation? 김경환(서울대학교병원)	Luncheon Seminar 5 좌장: 김영대(부산대학교병원) <메드트로닉코리아> Feasibility of Functional Preserving VATS Segmentectomy 박인규(서울대학교병원)	Luncheon Seminar 6 좌장: 김동관(서울아산병원) <한국의약품물류(주)> Role of Electromagnetic Navigation in Thoracic Surgery Dr. Lonny Yarmus, MD (Johns Hopkins Hospital, US)			12:30 ~ 13:30 흉부외과 여의사회 여성성과 리더쉽 광영숙 (제주대학교 정신과)
13:30 ~ 15:00	포럼 I (1 ~ 11 연제) 좌장: 정재승, 이승현	포럼 II (12 ~ 20 연제) 좌장: 이호석, 최용수	포럼 <성인> III (21 ~ 26 연제) 좌장: 오상기, 김근직			
15:00 ~ 15:30	Coffee Break					Coffee Break
15:30 ~ 17:00	관상동맥 (46 ~ 51 연제) 좌장: 정철현, 윤영남	최소침습 I (62 ~ 67 연제) 좌장: 김동관, 조덕곤	자유연제 <성인> II (77 ~ 82 연제) 좌장: 김 혁, 신윤철	15:30 ~ 17:00 식도/종격동 II (83 ~ 89 연제) 좌장: 나국주, 김대준		
17:00 ~ 17:30	시상식 및 행운상 추첨 - Medtronic Award 발표상 - English Competition Forum 발표상 - 젊은 연구자상(포럼) 발표상 - 최우수 포스터상					

제 4 일

2017년 11월 8일(수)
롯데 호텔 제주 연회동 6층

2017. 11. 8(수)	크리스탈 볼룸 1+2 성인심장	크리스탈 볼룸 3 일반홍부	펠 룸 소아심장	샤롯데룸
08:00~09:15	판막, 부정맥 II (90~95 연제) 좌장: 손호성, 박종빈	최소침습 II (102~106 연제) 좌장: 김동원, 김영대	포럼 <일반홍부> IV (27~36 연제) 좌장: 이해원, 조석기	메 드 트 로 닉 러 닝 센 터
09:15~10:30	기초/최소침습/외상 (96~101 연제) 좌장: 임상현, 임 청	폐암 III (107~112 연제) 좌장: 이종목, 김홍관	일반홍부 II (113~118 연제) 좌장: 이성호, 김재범	
10:30~11:00	Coffee Break			
11:00~12:00	Video Session (1~8 연제) 좌장: 진 응, 이성수			

대한흉부심장혈관외과학회 제49차 추계학술대회

프 로 그 램

구 연



둘째날 2017. 11. 6(일)

장소: 크리스탈 볼룸 1+2

08:00~09:00

판막, 부정맥 I (1~5 연제)

좌장: 김경환, 문병주

- 001 **Systematic Review and Meta-Analysis of Rapid Deployment Versus Conventional Aortic Valve Replacement**
Suk Ho Sohn, Kyung-Hwan Kim, Myoung-Jin Jang, Ho Young Hwang
Department of Thoracic and Cardiovascular Surgery, Medical Research Collaborating Center, Seoul National University Hospital, Seoul National University College of Medicine, Seoul, Korea
- 002 **Factors Affecting Surgical Outcomes in Behcet's Disease Patients with Severe Aortic Regurgitation**
Byeongzu Ghang¹, Jung Sun Lee¹, Joon Bum Kim², Sung-Ho Jung², Cheol Hyun Chung², Jae Won Lee², Jong Min Song³, Duk Hyun Kang³, Dae Hee Kim³, Oh Chan Kwon¹, Seokchan Hong¹, Yong-Gil Kim¹, Chang-Keun Lee¹, Bin Yoo¹, Suk Jung Choo²
¹*Division of Rheumatology, Department of Internal Medicine,* ²*Department of Thoracic and Cardiovascular Surgery,* ³*Division of Cardiology, Department of Internal Medicine, Asan Medical Center, Ulsan University College of Medicine, Seoul, Korea*
지정토론: 안 혁(서울대학교병원)
- 003 **Rosuvastatin Attenuates Degenerative Calcification of Bioprosthetic Heart Valve Through the Reduction of Interleukin-6 and Bone Morphogenic Protein-2 Expression**
Seung Hyun Lee, Byung Chul Chang, Young-Nam Youn, Hyun Chel Joo, Kyung-Jong Yoo, Sak Lee
Department of Thoracic and Cardiovascular Surgery, Severance Cardiovascular Hospital, Yonsei University College of Medicine, Seoul, Korea
- 004 **Pericardial Versus Porcine Valves for Surgical Aortic Valve Replacement**
Jeong-Won Kim, Wan Kee Kim, Min Ho Ju, Ho Jin Kim, Joon Bum Kim, Sung-Ho Jung, Suk Jung Choo, Cheol Hyun Chung, Jae Won Lee
Department of Thoracic and Cardiovascular Surgery, Asan Medical Center, Ulsan University College of Medicine, Seoul, Korea
- 005 **Clinical Impact of Atrial Activity after Maze Procedure for the Patients with Atrial Fibrillation**
Kang Min Kim, Suryeun Chung, Sang Yoon Kim, Dong Jung Kim, Jun Sung Kim, Cheong Lim, Kay-Hyun Park
Department of Thoracic and Cardiovascular Surgery, Seoul National University Bundang Hospital, Seoul National University College of Medicine, Gyeonggi-do, Korea

09:00~09:30 *Coffee Break*



09:30~11:00

자유연제 (6~12 연제)

좌장: 전상훈, 유경중

- 006 Non-intubated Thoracoscopic Surgery: Initial Experience of Single Center**
 Youngkyu Moon¹, Seha Ahn¹, Joon Pyo Jeon², Won Jung Hwang², Yunho Kim¹, Sook Whan Sung¹
¹Department of Thoracic and Cardiovascular Surgery, ²Department of Anesthesiology, Seoul St. Mary's Hospital, The Catholic University College of Medicine, Seoul, Korea
- 007 The Effect on Monocyte with Early Application of Adsorption Filter in Swine Trauma Model**
 Do Wan Kim, Gwan-Sic Kim, Kyo Seon Lee, Yo Chun Jung, Sang Ki Oh, Sang Yun Song, KooK Joo Na, Bong Suk Oh, Byoung Hee Ahn, In Seok Jeong
Department of Thoracic and Cardiovascular Surgery, Chonnam National University Hospital, Chonnam National University College of Medicine, Gwangju, Korea
- 008 Surgical Outcomes of Robot Assisted Minimally Invasive Versus Open Esophagectomy for Patients with Esophageal Squamous Cell Carcinoma: An Inverse Probability of Treatment Weighted Analysis**
 Byung Kwon Chong¹, Ho-jin Kim¹, Bum Soo Kim², Chan Wook Kim², In-Seob Lee², Chung-Sik Gong², Geun Dong Lee¹, Se Hoon Choi¹, Hyeong Ryul Kim¹, Dong Kwan Kim¹, Seung Il Park¹, Yong-Hee Kim¹
¹Department of Thoracic & Cardiovascular Surgery, ²Department of Surgery, Asan Medical Center, Ulsan University College of Medicine, Seoul, Korea
- 009 The Influence of Hepatic Dysfunction on Patients undergoing Tricuspid Valve Surgery**
 Hyung Gon Je¹, Mi Hee Lim¹, Sang-Kwon Lee¹, Ji Hye Lee², Hye Lim Oh²
¹Department of Cardiovascular and Thoracic Surgery, ²Research Institute for Convergence of Biomedical Science and Technology, Pusan National University Yangsan Hospital, Pusan National University College of Medicine, Gyeongsangnam-do, Korea
- 010 Trend Analysis for the Choice and Cost of Lung Cancer Treatment in South Korea, 2003-2013**
 Dohun Kim¹, Jong Hyock Park²
¹Department of Thoracic and Cardiovascular Surgery, ²Department of Health Science Business Convergence, Chungbuk National University Hospital, Chungbuk National University College of Medicine, Chungcheongbuk-do, Korea
- 011 How to Overcome the Gap in Perception between the Ideal Implementation of Trans-catheter Aortic Valve Replacement and the Reality? - Based on the Experience of Negotiations for Establishing a Guideline for Monitoring TAVR in Korea-**
 Suk Jung Choo¹, Sung Ho Shinn², Kyung Hwan Kim³, Wook Sung Kim⁴, Sam-Sae Oh⁵, Sak Lee⁶
¹Department of Thoracic and Cardiovascular Surgery, Asan Medical Center; Ulsan University College of Medicine, Seoul, ²Department of Thoracic and Cardiovascular Surgery, Eulji Hospital, Eulji University College of Medicine, Seoul, ³Department of Thoracic and Cardiovascular Surgery, Seoul National University Hospital, Seoul National University College of Medicine, Seoul, ⁴Department of Thoracic and Cardiovascular Surgery, Samsung Medical Center; Sungkyunkwan University School of Medicine, Seoul, ⁵Department of Thoracic and Cardiovascular Surgery, Kangbuk Samsung Medical Center; Sungkyunkwan University School of Medicine, Seoul, ⁶Division of Thoracic and Cardiovascular Surgery, Severance Cardiovascular Hospital, Yonsei University College of Medicine, Seoul, Korea
- 012 Long-term Durability of Bioprosthetic Valves at Right Ventricular Outflow Tract: Pericardial Valve Versus Porcine Valve**
 Jae Gun Kwak¹, Chang-Ha lee², Woong-Han Kim¹, Ji Hyun Bang¹, Beatrice Chia-Hui Shih¹, Sungkyu Cho², Jeong Ryul Lee¹, Yong Jin Kim²
¹Department of Thoracic and Cardiovascular Surgery, Seoul National University Children's Hospital, Seoul National University College of Medicine, Seoul, ²Department of Thoracic and Cardiovascular Surgery, Sejong General Hospital, Gyeonggi-do, Korea



11:00~12:00 **개회식 및 시상식**

- 개회식 및 축사
- 학술상 시상
 - Dr. Lillehei Merit Award
 - Ethicon Medical Award
 - 일동 학술상



12:00~13:00 Luncheon Seminar 1 좌장: 이재원(울산대학교 서울아산병원)

<메드트로닉코리아>

- 1. Permanent Pacemaker Implantation 장진근(제주한라병원 심장내과)
- 2. Update on Endovascular Treatment of Chronic Type IIIb Aortic Dissection 송석원(연세대학교 강남세브란스병원)
- 3. Surgical Modifications of Combined Maze Procedure: How I do It 이재원(울산대학교 서울아산병원)

13:00~14:00 특 강 1 좌장: 오탉윤

Invisible NIR Fluorescence for Image-Guided Surgery
Hak Soo Choi, PhD (Department of Radiology Harvard Medical School)

14:00~14:30 Medtronic 연구공로상 강연 및 시상 좌장: 심성보

이재원(울산대학교 서울아산병원)

14:30~15:00 회장강연 및 시상 좌장: 심성보

회장: 조재일(성균관대학교 삼성서울병원)

15:00~15:30 *Coffee Break*



16:30~17:30

대동맥 I (13~17 연제)

좌장: 박계현, 조광조

- 013 **Remnant Tear in the Aortic Arch branch is a Risk Factor for Major Adverse Aortic Events after Acute Type I Aortic Dissection Repair**
Woon Heo¹, Suk-Won Song¹, Tae-Hoon Kim¹, Shin-Young Lee¹, Min-Young Baek¹, Kyung-Jong Yoo², Bum-Koo Cho³
¹Department of Thoracic and Cardiovascular Surgery, Gangnam Severance Hospital, Yonsei University College of Medicine, Seoul, ²Department of Thoracic and Cardiovascular Surgery, Severance Hospital, Yonsei University College of Medicine, Seoul, Korea, ³The Korea Heart Foundation
- 014 **The Construction of Genetic Aortopathy Registry: Impact on Screening and Treatment of Family Members**
Suk Jung Choo, Hee Jung Kim, Ho Jin Kim, Joon Bum Kim, Sung-Ho Jung, Cheol Hyun Chung, Jae Won Lee
 Department of Thoracic and Cardiovascular Surgery, Asan Medical Center, Ulsan University College of Medicine, Seoul, Korea
- 015 **Clinical Outcomes of Repeated Surgeries for Thoracic Aorta**
 Hunbo Shim, Chang-Seok Jeon, Wook Sung Kim, Pyo Won Park, Young Tak Lee, Kiick Sung
 Department of Thoracic and Cardiovascular Surgery, Samsung Medical Center, Sungkyunkwan University School of Medicine, Seoul, Korea
- 016 **Risk Factor Analysis for Acute Subdural Hemorrhage after Aortic Surgery**
Kyo Seon Lee, Gwan Sic Kim, Yochun Jung, In Seok Jeong, Kook Joo Na, Bong Suk Oh, Byung Hee Ahn, Sang Gi Oh
 Department of Thoracic and Cardiovascular Surgery, Chonnam National University Hospital, Chonnam National University College of Medicine, Gwangju, Korea
- 017 **Impact of Direct Ascending Aortic Cannulation for Aortic Arch Surgery**
 Woo Seung Jang, Jae-Bum Kim, Jae Hyun Kim
 Department of Thoracic and Cardiovascular Surgery, Keimyung University Dongsan Medical Center, Keimyung University School of Medicine, Daegu, Korea



08:00~09:00

일반휴부 I (18~22 연제)

좌장: 백희중, 이응배

- 018 **Augmented Reality Smart Goggle for Intraoperative Fluorescence Image-guided Navigation Surgery**
 Hyun Koo Kim¹, Ki Hyeok Kwon², Yu Hua Quan², Jung Suk Heo², Kanghoon Lee¹, Kook Nam Han¹,
 Young Ho Choi¹, Beop-Min Kim²
¹Department of Thoracic and Cardiovascular Surgery, Korea University Guro Hospital, Korea University College of Medicine, Seoul, ²Department of Interdisciplinary Bio/Micro System Technology, Korea University College of Engineering, Seoul, Korea
- 019 **Changes in the Age of the First Occurrence of Primary Spontaneous Pneumothorax during the Last 20 Years**
 Joonho Jung, Jiye Park, Seokjin Haam
 Department of Thoracic and Cardiovascular Surgery, Ajou University Hospital, Ajou University School of Medicine, Gyeonggi-do, Korea
- 020 **Establishment of a Rejection Model for Lung Transplantation using a Rat**
 Woo Sik Yu¹, Jin-Mo Kim², Yoon Jin Cha³, Jee Won Suh⁴, Kyoung Shik Narm⁴, Hyo Chae Paik⁴, Jin Gu Lee⁴
¹Department of Thoracic Surgery, Armed Forces Capital Hospital, Gyeonggi-do, ²Department of Radiation Oncology, Severance Hospital, Yonsei University College of Medicine, Seoul, ³Department of Pathology, Gangnam Severance Hospital, Yonsei University College of Medicine, Seoul, ⁴Department of Thoracic and Cardiovascular Surgery, Severance Hospital, Yonsei University College of Medicine, Seoul, Korea
- 021 **Surgical Rebiopsy in Advanced Non-small Cell Lung Cancer Resistant to Previous Chemotherapy**
 Sumin Shin, Jong Ho Cho, Hong Kwan Kim, Yong Soo Choi, Jhngook Kim, Jae Ill Zo, Young Mog Shim
 Department of Thoracic and Cardiovascular Surgery, Samsung Medical Center, Sungkyunkwan University School of Medicine, Seoul, Korea
- 022 **Alternatively Activated Macrophage Correlate With Multi-drug Resistant Tuberculosis**
 Hyun Jin Cho¹, Jhngook Kim², Yun-Ji Lim³, Chang-Hwa Song³, Min-Woong Kang¹
¹Department of Thoracic and Cardiovascular Surgery, Chungnam National University Hospital, Chungnam National University College of Medicine, Daejeon, ²Department of Thoracic and Cardiovascular Surgery, Samsung Biomedical Research Institute, Samsung Medical Center, Sungkyunkwan University School of Medicine, Seoul, ³Department of Microbiology, Chungnam National University Hospital, Chungnam National University College of Medicine, Daejeon, Korea

09:00~09:30 Coffee Break

09:30~11:00

자유연제 (6~12 연제)

좌장: 전상훈, 유경중

11:00~12:00

개회식 및 시상식

- 개회식 및 축하
- 학술상 시상
 - Dr. Lillehei Merit Award
 - Ethicon Medical Award
 - 일동 학술상



둘째날 2017. 11. 6(월)

장소: 크리스탈 볼룸 3

12:00~13:00

Luncheon Seminar 2

좌장: 임 청(분당서울대학교병원)

<한국존슨앤드존슨메디칼>

Use of Harmonic Scalpel in Harvesting of Conduit

강준규(가톨릭대학교 서울성모병원)

둘째날 2017. 11. 6(월)

장소: 크리스탈 볼룸 1+2

13:00~14:00

특 강 1

좌장: 오태운

14:00~14:30

Medtronic 연구공로상 강연 및 시상

좌장: 심성보

14:30~15:00

회장강연 및 시상

좌장: 심성보

15:00~15:30

Coffee Break



16:30~17:30

폐암 I (23~27 연제)

좌장: 조재일, 김영태

- 023 **Prominent Immune Suppressive Tumor Microenvironment in Female Never-smoker Lung Cancer Patients with EGFR Mutations**
Byung-Jo Park, Da-Eun Ryu, Yong Soo Choi, Hong Kwan Kim, Jong Ho Cho, Jung Hee Lee, Jinseon Lee, Hae-Ock Lee, Je-Gun Joung, Woong-Yang Park, Jhingook Kim
Department of Thoracic and Cardiovascular Surgery, Samsung Medical Center, Sungkyunkwan University School of Medicine, Seoul, Korea
- 024 **Diffusing Capacity (DLco) Decrement following Neoadjuvant Concurrent Chemoradiotherapy: Implication on Postoperative Pulmonary Complications in Lung Cancer Patients**
Sumin Shin, Yong Soo Choi, Jae Jun Jung, Jong Ho Cho, Hong Kwan Kim, Jhingook Kim, Jae Ill Zo, Kwhanmien Kim, Young Mog Shim
Department of Thoracic and Cardiovascular Surgery, Samsung Medical Center, Sungkyunkwan University School of Medicine, Seoul, Korea
- 025 **Resection Margin Distance of Resected Lepidic-dominant Lung Cancer does Not Affect Recurrence after Sublobar Resection**
Youngkyu Moon, Jae Kil Park, Kyo Young Lee, Sook Whan Sung, Seok Whan Moon, Seha Ahn
Department of Thoracic and Cardiovascular Surgery, Seoul St. Mary's Hospital, The Catholic University College of Medicine, Seoul, Korea
- 026 **Early Clinical Outcomes from VATS Sleeve Resection and Bronchoplasty Utilizing 3D Thoracoscope**
Yong Won Seong, Dong Jin Kim, Hyo Joon Jang, Sukki Cho, Sanghoon Jheon, Kwhanmien Kim
Department of Thoracic and Cardiovascular Surgery, Seoul National University Bundang Hospital, Seoul National University College of Medicine, Gyeonggi-do, Korea
- 027 **Sublobar Resection for Clinical Stage 1A Lung Adenocarcinoma with Ground-glass Opacity**
Jae Hyun Jeon, Da Na Moon, Hee Chul Yang, Moon Soo Kim, Jong Mog Lee
Center for Lung Cancer, National Cancer Center, Gyeonggi-do, Korea



둘째날 2017. 11. 6(월)

장소: 펄 룸

08:00~09:00 **선천성심장질환 I (28~31 연제)** **좌장: 김용진, 전태국**

- 028 Search for the Ideal Conduit: Our Experience with Homemade Expanded Polytetrafluoroethylene Valved Conduit
 Eung Re Kim, Jae Hong Lim, Jooncheol Min, Jae Gun Kwak, Woong-Han Kim
 Department of Thoracic and Cardiovascular Surgery, Seoul National University Children's Hospital, Seoul National University College of Medicine, Seoul, Korea

- 029 Long-term Outcome of Homograft Monocusp Valve Inserted during Repair of Tetralogy of Fallot
 Ji Young Park, Tae-Gook Jun, Ji-Hyuk Yang, Pyo Won Park
 Departments of Thoracic and Cardiovascular Surgery, Samsung Medical Center, Sungkyunkwan University School of Medicine, Seoul, Korea
 지정토론: 장우성(계명대학교병원)

- 030 Excellent Durability and Bothersome Events after Mechanical Pulmonary Valve Replacement
 Yu Rim Shin, Young-Hwan Park, Han Ki Park
 Department of Thoracic and Cardiovascular Surgery, Severance Hospital, Yonsei University College of Medicine, Seoul, Korea
 지정토론: 신흥주(고려대학교 안산병원)

- 031 Intermediate-term Follow-up of Bioprosthetic Valve Function after Pulmonary Valve Implantation in Repaired Tetralogy of Fallot Patients
 Won Young Lee, Eun Seok Choi, Chun Soo Park, Tae-Jin Yun
 Department of Thoracic and Cardiovascular Surgery, Asan Medical Center, Ulsan University College of Medicine, Seoul, Korea

09:00~09:30 *Coffee Break*

둘째날 2017. 11. 6(월)

장소: 크리스탈 볼룸 1+2

09:30~11:00 **자유연제 (6~12 연제)** **좌장: 전상훈, 유경종**

11:00~12:00 **개회식 및 시상식**

- 개회식 및 축하
- 학술상 시상
 - Dr. Lillehei Merit Award
 - Ethicon Medical Award
 - 일등 학술상

둘째날 2017. 11. 6(월)

장소: 펄 룸



12:00~13:00

Luncheon Seminar 3

좌장: 최학수(Harvard Medical School), 이호석(부산대학교병원)

<인튜이티브 서지컬>

Fluorescent Image-Guided da Vinci Thoracic Surgery

Using Firefly and Endowrist Stapler

김현구(고려대학교 구로병원)

둘째날 2017. 11. 6(월)

장소: 크리스탈 볼룸 1+2

13:00~14:00

특 강 1

좌장: 오태운

14:00~14:30

Medtronic 연구공로상 강연 및 시상

좌장: 심성보

14:30~15:00

회장강연 및 시상

좌장: 심성보

15:00~15:30 *Coffee Break*



16:30~17:30

선천성심장질환 II (32~35 연제)

좌장: 성시찬, 이창하

- 032 How Small is too Small for Pulmonary Valve Annulus Preservation in the Repair of ToF?
Donghee Kim, Chun Soo Park, Eun Seok Choi, Bo Sang Kwon, Won Kyoung Park, Won Young Lee, Tae-Jin Yun
Department of Thoracic and Cardiovascular Surgery, Asan Medical Center, Ulsan University College of Medicine, Seoul, Korea
- 033 Short-term Outcomes after Total Correction with Pulmonary Valve and Right Ventricular Preservation in Tetralogy of Fallot Patients
Jae Gun Kwak, Woong-Han Kim
Department of Thoracic and Cardiovascular Surgery, Seoul National University Children's Hospital, Seoul National University College of Medicine, Seoul, Korea
지정토론: 김형태(양산부산대학교병원)
- 034 Outcomes of Neonatal Repair in Tetralogy of Fallot with Ductal Dependent Pulmonary Atresia
Chang-Ha Lee¹, Sungkyu Cho¹, Eun Seok Choi², Yong Jin Kim¹
¹Department of Cardiovascular Surgery, Sejong General Hospital, Gyeonggi-do, ²Divisions of Pediatric Cardiac Surgery and Pediatric Cardiology, Asan Medical Center, Ulsan University College of Medicine, Seoul, Korea
- 035 Improvement in Cardiopulmonary Exercise Capacity and its Associated Factors after Pulmonary Valve Replacement in Repaired Tetralogy of Fallot Patients
Yu Rim Shin, Young-Hwan Park, Han Ki Park
Department of Thoracic and Cardiovascular Surgery, Severance Hospital, Yonsei University College of Medicine, Seoul, Korea
지정토론: 이 철(가톨릭대학교 서울성모병원)



08:00~09:00

체외순환 (36~40 연제)

좌장: 이석재, 김형수

- 036 **Early Experience of Durable Left Ventricular Assist Devices: Do we Need Bridge-to-transplant Strategy in Korea?**
Jun Ho Lee, Yang Hyun Cho, Dong Seop Jeong, Ji-Hyuk Yang, Kiick Sung, Wook Sung Kim, Tae-Gook Jun, Young Tak Lee, Pyo Won Park
Department of Thoracic and Cardiovascular Surgery, Samsung Medical Center, Sungkyunkwan University School of Medicine, Seoul, Korea
- 037 **Extracorporeal Membrane Oxygenation Support in Organ Transplant Donors**
 Hong Chul Oh, Young Woo Park, Won Ho Chang
Department of Thoracic and Cardiovascular Surgery, Soonchunhyang University Hospital Seoul, Soonchunhyang University College of Medicine, Seoul, Korea
지정토론: 조양현(성균관대학교 삼성서울병원)
- 038 **Learning Curve of Venovenous Extracorporeal Membrane Oxygenation Treatment: How Many Experiences are Necessary for Acceptable Results of Venovenous Extracorporeal Membrane Oxygenation Treatment?**
Jong Myung Park, Bong Soo Son, Hee Je Sim, Do Hyung Kim
Department of Thoracic and Cardiovascular Surgery, Pusan National University Yangsan Hospital, Pusan National University College of Medicine, Gyeongsangnam-do, Korea
- 039 **Near-infrared Spectroscopy Monitoring for Early Detection of Limb Ischemia in Patients on Venovenous Extracorporeal Membrane Oxygenation**
Dong Jung Kim, Sang Yoon Kim, Su Ryeun Chung, Jun Sung Kim, Cheong Lim, Kay-Hyun Park
Department of Thoracic and Cardiovascular Surgery, Seoul National University Bundang Hospital, Seoul National University College of Medicine, Gyeonggi-do, Korea
- 040 **Predictive Value of Procalcitonin for Infection and Survival in Adult Cardiogenic ECMO**
Do Wan Kim, Gwan Sic Kim, Kyo Seon Lee, Yo Chun Jung, Sang Gi Oh, Sang Yun Song, Kook Joo Na, Byoung Hee Ahn, Bong Suk Oh, In Seok Jeong
Department of Thoracic and Cardiovascular Surgery, Chonnam National University Hospital, Chonnam National University College of Medicine, Gwangju, Korea



09:00~10:00 대동맥 II (41~45 연제) 좌장: 주석중, 성기익

- 041 Isthmus Aortic Narrowing after Thoracic Endovascular Aortic Repair(TEVAR)in Traumatic Aortic Transection**
 Jung Taek Kim, Wan Ki Baek, Yong Han Yoon, Young Sam Kim, Ji Hae kim, Yong Zik Lee, Jeong Im Cho, Ju Hyun Sung, Chang Wan So
Department of Thoracic and Cardiovascular Surgery, Inha University Hospital, Inha University College of Medicine, Incheon, Korea
- 042 Aortic Remodeling of Stentless-thoracic Endovascular Aortic Repair in Chronic DeBakey IIIb Aneurysm**
 Tae Hoon Kim¹, Suk-Won Song¹, Woon Heo¹, Won Gi Woo¹, Min-Young Baek¹, Kyung-Jong Yoo², Bum-Koo Cho³
¹Department of Thoracic and Cardiovascular Surgery, Gangnam Severance Hospital, Yonsei University College of Medicine, Seoul, ²Department of Cardiovascular Surgery, Gangnam Severance Hospital, Yonsei University College of Medicine, Seoul, Korea, ³The Korea Heart Foundation
- 043 The Fate of Unrepaired Type A Chronic Aortic Dissection**
 Wan Kee Kim¹, Hee Jung Kim², Min Ho Ju¹, Ho Jin Kim¹, Joon Bum Kim¹, Sung-Ho Jung¹, Suk Jung Choo¹, Cheol Hyun Chung¹, Jae Won Lee¹
¹Department of Thoracic and Cardiovascular Surgery, Asan Medical Center, Ulsan University College of Medicine, Seoul, ²Department of Thoracic and Cardiovascular Surgery, Sejong General Hospital, Gyeonggi-do, Korea
- 044 Subclavian Artery Cannulation Can Reduce the Early Embolic Stroke after Open Arch Surgery with Circulatory Arrest**
 Jung-Hwan Kim, Seung Hyun Lee, Sak Lee, Young-Nam Youn, Kyung-Jong Yoo, Byung-Chel Chang, Hyun-Chel Joo
Department of Cardiovascular Surgery, Severance Cardiovascular Hospital, Yonsei University College of Medicine, Seoul, Korea
- 045 Roll of Intraoperative Motor-evoked Potentials and Postoperative Paraplegia in Thoraco-abdominal Aortic Aneurysm Surgery**
 Heemoon Lee, Kiick Sung, Yang Hyun Cho, Dong Seop Jeong, Wook Sung Kim, Young Tak Lee, Pyo-Won Park
Department of Thoracic and Cardiovascular Surgery, Samsung Medical Center, Sungkyunkwan University School of Medicine, Seoul, Korea

10:00~10:30 *Coffee Break*

10:30~11:30 외부 초청강의

- 10:30~11:00 <제니스팜> **좌장: 성기익(성균관대학교 삼성서울병원)**
 Minimally Invasive Cardiac Surgery: Do We Need Novel Cardioprotective Strategies?
 Prof. Garbor Balazs Szabo, MD (University of Heidelberg, Germany)
- 11:00~11:30 <(주)한솔카디악케어> **좌장: 장병철(차의과학대학교 분당차병원)**
 Sutureless Valves Update on Consensus Paper and Tips/Tricks to
 a Successful Percutaneous Sutureless Valve Implantation
 Peter J. Oberwalder, MD (Division Cardiac Surgery, Medical School Graz, Austria)



11:30~12:30 **총회 및 시상식**

1. 위원장보고
2. 학술상 시상
 - Medtronic Recognition Awards
 - 이영균 우수논문상
 - 한국심장재단 우수논문상
 - 흉부외과 의료 봉사상
3. 임원 인준

12:30~13:30 **Luncheon Seminar 4**

좌장: 이재원(울산대학교 서울아산병원)

<에드워즈라이프사이언시스 코리아>

Rapid Deployment Valve: Can it Replace Conventional Tissue Valve Operation?

김경환(서울대학교병원)

15:00~15:30 *Coffee Break*



15:30~17:00

관상동맥 (46~51 연제)

좌장: 정철현, 운영남

- 046 Ten-years Survival Comparison between Surgical Off-pump Coronary Revascularization and PCI
 Gijong Yi¹, Young-Nam Youn², Kyung-Jong Yoo²
¹Department of Thoracic and Cardiovascular Sugery, Gangnam Severance Hospital, Seoul, ²Department of Thoracic and Cardiovascular Sugery, Severance Cardiovascular Hospital, Yonsei University College of Medicine, Seoul, Korea
- 047 Clinical Usefulness of Preoperative Thoracoabdominal Multidetector Computed Tomographic Angiography in Patients undergoing Coronary Artery Bypass Grafting
 Kwon Joong Ng, Jae-Woong Choi, Ho Young Hwang, Ki-Bong Kim
 Department of Thoracic and Cardiovascular Surgery, Seoul National University Hospital, Seoul National University College of Medicine, Seoul, Korea
- 048 Saphenous Vein as a Composite Graft: Clinical Outcomes and Patency Compared with Aorto-coronary Graft
 Jung-Hwan Kim, Seung Hyun Lee, Hyun-Chel Joo, Kyung-Jong Yoo, Young-Nam Youn
 Department of Cardiovascular Surgery, Severance Cardiovascular Hospital, Yonsei University College of Medicine, Seoul, Korea
 지정토론: 황호영(서울대학교병원)
- 049 Analysis of Contributing Factors for Early Graft Obstruction in Small Target Coronary Artery
 Jungsuk Choi, Jun Lee, Min Namkung, Wonjung Cho, Hyung joo Park, Hyun Song, Joonkyu Kang
 Department of thoracic and cardiovascular surgery, Seoul St. Mary's Hospital, The Catholic University College of Medicine, Seoul, Korea
- 050 Dual Antiplatelet Therapy after Coronary Artery Bypass Grafting in Acute Coronary Syndrome: A Real-world Comparison between Clopidogrel and Ticagrelor
 Hyoung Woo Chang, Hee Jung Kim, Jae Suk Yoo, Dong Jin Kim, Kwang Ree Cho
 Department of Thoracic and Cardiovascular Surgery, Sejong General Hospital, Gyeonggi-do, Korea
- 051 Bilateral Versus Single Internal Thoracic Artery: Which One is Better in the Patients with LV Dysfunction?
 Suryeun Chung, Sang Yoon Kim, Dong Jung Kim, Jun Sung Kim, Kay-Hyun Park, Cheong Lim
 Department of Thoracic and Cardiovascular Surgery, Seoul National University Bundang Hospital, Seoul National University College of Medicine, Gyeonggi-do, Korea
 지정토론: 조광리(세종병원)

17:00~17:30

시상식 및 행운상 추첨

- Medtronic Award 발표상
- English Competition Forum 발표상
- 젊은 연구자상(포럼) 발표상
- 최우수 포스터상



08:00~09:00

폐암 II (52~56 연제)

좌장: 김관민, 김현구

- 052 **Limited Resection Versus Lobectomy in T1AN0M0 Lung Cancer: Population Based, Propensity Score Matched Study**
 Jae Kil Park, Young Kyu Moon, Kyung Soo Kim, Hyung Joo Park, Sook Whan Sung, Seok Whan Moon, Mi Hyoung Moon
Department of Thoracic and Cardiovascular Surgery, Seoul St. Mary's Hospital, The Catholic University College of Medicine, Seoul, Korea
- 053 **Outcomes of Surgical Treatment of Non-small Cell Lung Cancer with Synchronous Brain Metastasis**
Tae Ho Kim¹, Hong Kwan Kim¹, Jung-Il Lee², Sumin Shin¹, Jong Ho Cho¹, Yong Soo Choi¹, Jhingook Kim¹, Jae Ill Zo¹, Young Mog Shim¹
¹Department of Thoracic and Cardiovascular Surgery, ²Department of Neurosurgery, Samsung Medical Center, Sungkyunkwan University School of Medicine, Seoul, Korea
- 054 **Influence of Insurance Status on Survival of Patients with Non-small Cell Lung Cancer Underwent Surgical Treatment**
YooHwa Hwang, Mi Sun Shin, Hyeon Jong Moon, Sang Yoon Yeom, Se-Jin Oh, Jae-sung Choi
Department of Thoracic and Cardiovascular Surgery, SMG-SNU Boramae Medical Center, Seoul National University College of Medicine, Seoul, Korea
- 055 **Prognostic Significance of Neutrophil-Lymphocyte Ratio in Patients Undergoing Pulmonary Metastasectomy for Metastatic Renal Cell Carcinoma**
Dong Woog Yoon¹, Hong Kwan Kim¹, Seong Il Seo², Sumin Shin¹, Jong Ho Cho¹, Yong Soo Choi¹, Jhingook Kim¹, Jae Ill Zo¹, Young Mog Shim¹
¹Department of Thoracic and Cardiovascular Surgery, ²Department of Urology, Samsung Medical Center, Sungkyunkwan University School of Medicine, Seoul, Korea
- 056 **The Significance of Lobe-specific Emphysema Index for the Prediction of Prolonged Air Leak in Anatomical Segmentectomy**
Duk Hwan Moon, Sungsoo Lee
Department of Thoracic and Cardiovascular Surgery, Gangnam Severance Hospital, Yonsei University College of Medicine, Seoul, Korea



09:00~10:00

식도/종격동 I (57~61 연제)

좌장: 김용희, 강창현

- 057 Outcomes and Prognostic Factors of Neoadjuvant Concurrent Chemoradiotherapy followed by Esophagectomy for Thoracic Esophageal Squamous Cell Carcinoma**
 Hong Kwan Kim¹, Sumin Shin¹, Jong Ho Cho¹, Yong Soo Choi¹, Kwhannien Kim², Jae Ill Zo¹, Keunchil Park³, Myung-Ju Ahn³, Jong-Mu Sun³, Yong Chan Ahn⁴, Dongryul Oh⁴, Young Mog Shim¹
¹Department of Thoracic and Cardiovascular Surgery, Samsung Medical Center, Sungkyunkwan University School of Medicine, Seoul, ²Department of Thoracic and Cardiovascular Surgery, Seoul National University Bundang Hospital, Seoul National University College of Medicine, Gyeonggi-do, ³Division of Hematology-Oncology, Department of Medicine, ⁴Department of Radiation Oncology, Samsung Medical Center, Sungkyunkwan University School of Medicine, Seoul, Korea
- 058 Different Modalities Affecting Survival in Stage IIB (T1-2, N0-1) Esophageal Squamous Cell Carcinoma, Propensity Score Matched Analysis using Population Based Study**
 Jae Kil Park, Young Kyu Moon, Kyung Soo Kim, Hyung Joo Park, Sook Whan Sung, Seok Whan Moon, Mi Hyoung Moon
 Department of Thoracic and Cardiovascular Surgery, Seoul St. Mary's Hospital, The Catholic University College of Medicine, Seoul, Korea
- 059 Prevalence and Risk Factors of Reflux after Esophagectomy for Esophageal Cancer**
 Samina Park, Kwanyong Hyun, Hyun Joo Lee, In Kyu Park, Young Tae Kim, Chang Hyun Kang
 Department of Thoracic and Cardiovascular Surgery, Seoul National University Hospital, Seoul National University College of Medicine, Seoul, Korea
- 060 Nomogram Predicting Recurrence After Complete Resection for Thymic Epithelial Tumors Based on the TNM Classification**
 Geun Dong Lee¹, Hyeong Ryul Kim¹, Su Kyung Hwang¹, Se Hoon Choi¹, Yong-Hee Kim¹, Dong Kwan Kim¹, Seung-Il Park¹, Jae Jun Jung², Sumin Shin², Jong Ho Cho², Hong Kwan Kim², Yong Soo Choi², Jhingook Kim², Jae Il Zo², Young Mog Shim², Samina Park³, Kwan Yong Hyun³, Yoohwa Hwang³, Hyun Joo Lee³, In Kyu Park³, Chang Hyun Kang³, Young Tae Kim³, Chang Young Lee⁴, Jin Gu Lee⁴, Dae Joon Kim⁴, Hyo Chae Paik⁴, Kyoung Young Chung⁴
¹Department of Thoracic and Cardiovascular Surgery, Asan Medical Center, Ulsan University College of Medicine, Seoul, ²Department of Thoracic and Cardiovascular Surgery, Samsung Medical Center, Sungkyunkwan University School of Medicine, Seoul, ³Department of Thoracic and Cardiovascular Surgery, Seoul National University Hospital, Seoul National University College of Medicine, Seoul, ⁴Department of Thoracic and Cardiovascular Surgery, Severance Hospital, Yonsei University College of Medicine, Seoul, Korea
- 061 Long-term Survival and Prognosis of Surgically Treated Thymic Carcinoma: A Multi-institutional Study of 239 Cases**
 Yeong Jeong Jeon¹, Yong Soo Choi¹, Jae Jun Jung¹, Sumin Shin¹, Jong Ho Cho¹, Hong Kwan Kim¹, Jhingook Kim¹, Jae Il Zo¹, Young Mog Shim¹, Samina Park², Kwan Yong Hyun², Yoohwa Hwang², Hyun Joo Lee², In Kyu Park², Chang Hyun Kang², Young Tae Kim², Geun Dong Lee³, Hyeong Ryul Kim³, Su Kyung Hwang³, Se Hoon Choi³, Yong-Hee Kim³, Dong Kwan Kim³, Seung-Il Park³, Chang Young Lee⁴, Jin Gu Lee⁴, Dae Joon Kim⁴, Hyo Chae Paik⁴, Kyoung Young Chung⁴
¹Department of Thoracic and Cardiovascular Surgery, Samsung Medical Center, Sungkyunkwan University School of Medicine, Seoul, ²Department of Thoracic and Cardiovascular Surgery, Seoul National University Hospital, Seoul National University College of Medicine, Seoul, ³Department of Thoracic and Cardiovascular Surgery, Asan Medical Center, Ulsan University College of Medicine, Seoul, ⁴Department of Thoracic and Cardiovascular Surgery, Severance Hospital, Yonsei University College of Medicine, Seoul, Korea

10:00~10:30 Coffee Break

셋째날 2017. 11. 7(화)

장소: 크리스탈 볼룸 1+2



10:30~11:30 **외부 초청강의**

11:30~12:30 **총회 및 시상식**



12:30~13:30

Luncheon Seminar 5

좌장: 김영대(부산대학교병원)

<메트로닉코리아>

Feasibility of Functional Preserving VATS Segmentectomy

박인규(서울대학교병원)

15:00~15:30 *Coffee Break*

15:30~17:00

최소침습 I (62~67 연제)

좌장: 김동관, 조덕근

- 062 Factors Affecting Efficacy of Intraoperative Localization of Small Peripheral GGN with Electromagnetic Navigation Bronchoscopy
 Kwanyong Hyun, In Kyu Park, Samina Park, Yoohwa Hwang, Hyun Joo Lee, Chang Hyun Kang, Young Tae Kim
 Department of Thoracic and Cardiovascular Surgery, Seoul National University Hospital, Seoul National University College of Medicine, Seoul, Korea
 지정토론: 한국남(고려대학교 구로병원)
- 063 Does Lung Resection Volume Influence on the Recurrence for Primary Spontaneous Pneumothorax?
 Si Young Choi¹, Young-Du Kim², Hyun Woo Jeon², Jong Hui Suh³, Deog Gon Cho⁴, Chan Beom Park³, Jin Yong Jeong³, Jeong Seob Yoon³, Do Yeon Kim³, Yong Hwan Kim¹, Seong Cheol Jeong¹, In Seop Kim¹, Jae Jun Kim¹
¹Department of Thoracic and Cardiovascular Surgery, Uijeongbu St. Mary's Hospital, The Catholic University College of Medicine, Gyeonggi-do, ²Department of Thoracic and Cardiovascular Surgery, Bucheon St. Mary's Hospital, College of Medicine, The Catholic University of Korea, ³Department of Thoracic and Cardiovascular Surgery, Incheon St. Mary's Hospital, The Catholic University College of Medicine, Incheon, ⁴Department of Thoracic and Cardiovascular Surgery, St. Vincent's Hospital, The Catholic University College of Medicine, Gyeonggi-do, Korea
- 064 Comparison of Oncological Outcomes of Single-port Versus Multi-port Video-assisted Thoracoscopic Lobectomy for Non-small-cell Lung Cancer: A Propensity-matched Analysis
 Dong Woog Yoon, Jae Jun Jung, Genehee Lee, Jong Ho Cho, Yong Soo Choi
 Department of Thoracic and Cardiovascular Surgery, Samsung Medical Center, Sungkyunkwan University School of Medicine, Seoul, Korea
- 065 Pain Control after Single-port VATS: ETOIMS as an Alternative to IV-PCA
 Duk Hwan Moon, Sungsoo Lee
 Department of Thoracic and Cardiovascular Surgery, Gangnam Severance Hospital, Yonsei University College of Medicine, Seoul, Korea
- 066 Fluorescent Iodized Emulsion for Preoperative Localization of Pulmonary Nodule
 Hyun Koo Kim¹, Ji Yun Rho¹, Jae Wook Lee², Yu Hua Quan¹, Byeong Hyeon Choi¹, Rong Xu¹, Kanghoon Lee¹, Kook Nam Han¹, Young Ho Choi¹, Hwan Seok Yong²
¹Department of Thoracic and Cardiovascular Surgery, ²Department of Radiology, Korea University Guro Hospital, Korea University College of Medicine, Seoul, Korea
- 067 Comparison of Single Versus Three Intercostal Nerve Block by Continuous Extrapleural Analgesia in Single Incisional Thoracoscopic Surgery
 Kook Nam Han, Hyun Joo Lee, Hyun Koo Kim, Young Ho Choi
 Department of Thoracic and Cardiovascular Surgery, Korea University Guro Hospital, Korea University College of Medicine, Seoul, Korea

17:00~17:30

시상식 및 행운상 추첨

장소: 크리스탈 볼룸 1+2



08:00~09:00

선천성심장질환 III (68~71 연제)

좌장: 박영환, 김응한

- 068 **Early and Late Outcomes after Late Bidirectional Cavopulmonary Shunt**
Yu Rim Shin, Young-Hwan Park, Han Ki Park
Department of Thoracic and Cardiovascular Surgery, Severance Hospital, Yonsei University College of Medicine, Seoul, Korea
- 069 **Surgical Interventions after the Fontan Operation**
Won Kyoum Park, Eun Seok Choi, Chun Soo Park, Tae-Jin Yun
Department of Pediatric Cardiac Surgery, Asan Medical Center, Ulsan University College of Medicine, Seoul, Korea
 지정토론: 곽재건(서울대학교병원)
- 070 **Heart Transplantation for Failing from Single Ventricle Palliation or One-and-a-half Ventricle Physiology: A Single-institution Experience**
Bo Bae Jeon, Chun Soo Park, Tae-Jin Yun
Division of Pediatric Cardiac Surgery, Asan Medical Center, Ulsan University College of Medicine, Seoul, Korea
 지정토론: 양지혁(성균관대학교 삼성서울병원)
- 071 **Pulmonary Artery Growth after Surgical Management of Pulmonary Artery Slings**
Ji Young Park, Tae-Gook Jun, Ji-Hyuk Yang, Pyo Won Park
Departments of Thoracic and Cardiovascular Surgery, Samsung Medical Center, Sungkyunkwan University School of Medicine, Seoul, Korea

09:00~10:00

선천성심장질환 IV (72~76 연제)

좌장: 김시호, 이정렬

- 072 **Multidisciplinary Counselling Reduces Rate of Abortion and Improves Clinical Outcomes of Prenatally Diagnosed Congenital Heart Disease Patients**
Jae Hong Lim, Joon Cheol Min, Eung Rae Kim, Jae Gun Kwak, Bongyeon Sohn, Woong-Han Kim
Department of Thoracic and Cardiovascular Surgery, Seoul National University Children's Hospital, Seoul National University College of Medicine, Seoul, Korea
- 073 **Impact of Prenatal Diagnosis on the Outcome of Absent Pulmonary Syndrome**
You Jung Ok, Bo Sang Kwon, Tae-Jin Yun
Department of Thoracic and Cardiovascular Surgery, Asan Medical Center, Ulsan University College of Medicine, Seoul, Korea
- 074 **Pulmonary Artery Banding in Very-low-birth-weight Premature Infants in Neonatal Intensive Care Unit**
Joo Yeon Kim, Tae-Gook Jun, Ji-Hyuk Yang
Department of Thoracic and Cardiovascular Surgery, Samsung Medical Center, Sungkyunkwan University School of Medicine, Seoul, Korea
 지정토론: 정인석(전남대학교병원)
- 075 **Utilization of 3-D Printed Heart Model in the Surgical Treatment of DORV with Remote VSD**
Donghee Kim, Chun Soo Park, Eun Seok Choi, Bo Sang Kwon, Won Kyoum Park, Won Young Lee, Tae-Jin Yun
Department of Thoracic and Cardiovascular Surgery, Asan Medical Center, Ulsan University College of Medicine, Seoul, Korea
- 076 **Risk Factors of 30-day-mortality after Arterial Switch Operation; Neoaorta-reconstruction-first Technique can make Difference**
Kwang Ho Choi¹, Si Chan Sung¹, Hyungtae Kim¹, Hyoung Doo Lee², Geena Kim², Hoon Ko²
¹Department of Thoracic and Cardiovascular Surgery, ²Department of Pediatric cardiology, Pusan National University Yangsan Hospital, Pusan National University College of Medicine, Gyeongsangnam-do, Korea
 지정토론: 박정준(이화여자대학교 목동병원)



셋째날 2017. 11. 7(화)

장소: 펄 룸

10:00~10:30 *Coffee Break*

셋째날 2017. 11. 7(화)

장소: 크리스탈 볼룸 1+2

10:30~11:30 **외부 초청강의**

11:30~12:30 **총회 및 시상식**



12:30~13:30

Luncheon Seminar 6

좌장: 김동관(서울아산병원)

<한국의약품물류(주)>

Role of Electromagnetic Navigation in Thoracic Surgery

Dr. Lonny Yarmus, MD (Johns Hopkins Hospital, US)

15:00~15:30 Coffee Break

15:30~17:00

자유연제 <성인> II (77~82 연제)

좌장: 김 혁, 신윤철

- 077 Long-term Outcomes of Mitral Valve Repair for Degenerative Mitral Regurgitation using Rigid or Flexible Annuloplasty Ring
Jung-Hwan Kim, Seung Hyun Lee, Hyun-Chel Joo, Sak Lee, Young-Nam Youn, Kyung-Jong Yoo, Byung-Chul Chang
Department of Cardiovascular Surgery, Severance Cardiovascular Hospital, Yonsei University College of Medicine, Seoul, Korea
- 078 Fragility of Red Blood Cells Collected under Different Conditions with a Cell Saver Device: an Animal Study
Yoon Sang Chung, Dai Yun Cho, Dong Suep Sohn, Hyuck Kim, Hye Ryoum Kim, Hyun Kang, Byungjoon Park, Joonhwa Hong
Department of Thoracic and Cardiovascular Surgery, Chung-Ang University Hospital, Chung-Ang University College of Medicine, Seoul, Korea
- 079 Impact of Sex and Body Weight Mismatch on Mid-term Outcomes After Heart Transplantation
Jung-Hwan Kim, Seung Hyun Lee, Hyun-Chel Joo, Sak Lee, Han-Ki Park, Kyung-Jong Yoo, Byung-Chul Chang, Young-Nam Youn
Department of Cardiovascular Surgery, Severance Cardiovascular Hospital, Yonsei University College of Medicine, Seoul, Korea
- 080 The Association between Morphological and Functional Characteristics of Bicuspid Aortic Valve and Bicuspid Aortopathy
Sung Jun Lee¹, Je Kyoum Shin¹, Hyun Keun Chee¹, Jun Suk Kim¹, Sung Min Ko²
¹*Department of Thoracic and Cardiovascular Surgery, ²Department of Radiology, Konkuk University Medical Center, Konkuk University School of Medicine, Seoul, Korea*
- 081 Pre-sewn Eight-branched Aortic Graft for Crawford Extent II Thoracoabdominal Aortic Aneurysm Repair
Hong Rae Kim¹, Sung Jun Park¹, Joon Bum Kim²
¹*Department of Thoracic and Cardiovascular Surgery, Armed Forces Daegu Hospital, Daegu, ²Department of Thoracic and Cardiovascular Surgery, Asan Medical Center, Ulsan University College of Medicine, Seoul, Korea*
- 082 Central Type Cannulation Conversion from Peripheral Venoarterial Extracorporeal Membrane Oxygenation
Ji young Park, Yang Hyun Cho, Yong Tak Lee, Wook Sung Kim, Kiick Sung, Dong Seop Jeong, Pyo Won Park
Departments of Thoracic and Cardiovascular Surgery, Samsung Medical Center, Sungkyunkwan University School of Medicine, Seoul, Korea

17:00~17:30

시상식 및 행운상 추첨

장소: 크리스탈 볼룸 1+2



09:00~10:00 **지도전문의 교육**

09:00~09:20	전공의 연차별 수련 목표 및 내용	정인석(전남대학교병원)
09:20~09:40	전문의 자격시험 및 취득 요건	최창휴(가천대학교 길병원)
09:40~10:00	전공의 수련 프로그램의 효과적인 평가방법	이석재(제주대학교병원)

12:30~13:30 **흉부외과 여의사회**

12:30~13:30	여성성과 리더쉽	곽영숙(제주대학교 정신과)
-------------	----------	----------------

15:00~15:30 *Coffee Break*



15:30~17:00

식도/종격동 II (83~89 연제)

좌장: 나국주, 김대준

- 083 Revalidation of the Postneoadjuvant Pathologic TNM Stage of Esophageal Squamous Cell Carcinoma**
Han Pil Lee, Min Kyun Kang, Byung Kwon Chong, Jin San Bok, Geun Dong Lee, Se Hoon Choi, Yong-Hee Kim, Seung Il Park, Dong Kwan Kim, Hyeong Ryul Kim
Department of Thoracic & Cardiovascular Surgery, Asan Medical Center; Ulsan University College of Medicine, Seoul, Korea
- 084 Postoperative Endoscopy for the Evaluation of Local Complications after Esophagectomy**
Jae Hyun Jeon, Da Na Moon, Hee Chul Yang, Moon Soo Kim, Jong Mog Lee
Center for Lung Cancer, National Cancer Center, Gyeonggi-do, Korea
- 085 Comparison of Japanese Staging System and AJCC 7th, 8th Staging System in Esophageal Squamous Cell Carcinoma Patients**
Seong Yong Park, Dae Joon Kim, Jee Won Suh, Go Eun Byun, Kyoung Sik Narm, Chang Young Lee, Jin Gu Lee, Hyo Chae Paik, Kyoung Young Chung
Department of Thoracic and Cardiovascular Surgery, Severance Hospital, Yonsei University College of Medicine, Seoul, Korea
- 086 Risk Factors for Weight Loss One-year after Esophagectomy for Esophageal Cancer**
Seong Yong Park, Dae Joon Kim, Jee Won Suh, Go Eun Byun, Kyoung Sik Narm, Chang Young Lee, Jin Gu Lee, Hyo Chae Paik, Kyoung Young Chung
Department of Thoracic and Cardiovascular Surgery, Severance Hospital, Yonsei University College of Medicine, Seoul, Korea
- 087 Laparoscopic Repair of Hiatal Hernia**
Ju Sik Yun¹, Kook Joo Na¹, Gwan Sic Kim², Kyo Seon Lee², Do Wan Kim², Yochun Jung², In Seok Jeong², Bong-Suk Oh², Byoung Hee Ahn², Seok Kim¹, Sang Yun Song¹
¹*Department of Thoracic and Cardiovascular Surgery, Chonnam National University Hwasun Hospital, Chonnam National University College of Medicine, Jeollanam-do, ²Department of Thoracic and Cardiovascular Surgery, Chonnam National University Hospital, Chonnam National University College of Medicine, Gwangju, Korea*
- 088 Robotic Thymectomy in Thymic Epithelial Tumors: Propensity Score Matching Study of 112 Consecutive Cases**
Samina Park, Kwanyong Hyun, Hyun Joo Lee, In Kyu Park, Young Tae Kim, Chang Hyun Kang
Department of Thoracic and Cardiovascular Surgery, Seoul National University Hospital, Seoul National University College of Medicine, Seoul, Korea
- 089 Dramatic Size Reduction of Thymic Neoplasm after Neoadjuvant Treatment could Not Improve R0 Resection Rate and Survival**
Jee Won Suh, Jin Gu Lee, Go Eun Byun, Kyoung Sik Narm, Chang Young Lee, Seong Yong Park, Dae Joon Kim, Kyoung Young Chung
Department of Thoracic and Cardiovascular Surgery, Severance Hospital, Yonsei University College of Medicine, Seoul, Korea



08:00~09:15 **판막, 부정맥 II (90~95 연제)** **좌장: 손호성, 박종빈**

- 090 **Progression of Functional Tricuspid Regurgitation and Impact of Concomitant Tricuspid Annuloplasty at the Time of Mitral Valve Repair for Degenerative Mitral Regurgitation**
Jung-Hwan Kim, Seung Hyun Lee, Hyun-Chel Joo, Young-Nam Youn, Kyung-Jong Yoo, Byung-Chul Chang, Sak Lee
Department of Cardiovascular Surgery, Severance Cardiovascular Hospital, Yonsei University College of Medicine, Seoul, Korea
- 091 **Rapid Deployment Edwards INTUITY Valve System and Conduction Disturbance Issue**
Ho Hyun Ko, Wan Kee Kim, Min Ho Ju, Ho Jin Kim, Joon Bum Kim, Sung-Ho Jung, Suk Jung Choo, Cheol Hyun Chung, Jae Won Lee
Department of Thoracic and Cardiovascular Surgery, Asan Medical Center, Ulsan University College of Medicine, Seoul, Korea
- 092 **Initial Experience of Sutureless Valve and Rapid Deployment Valve**
Soonchang Hong, Chun Sung Byun, Chang Hwan Kim, Kwan wook Kim, Joong hwan Oh
Department of Thoracic and Cardiovascular surgery, Wonju Severance Christian Hospital, Yonsei University College of Medicine, Gangwon-do, Korea
지정토론: 문병주(Southlake Regional Health Centre)
- 093 **Patch Augmentation of the Posterior Mitral Leaflet for Proper Coaptation Height**
Joon Young Song, Jong Hun Kim, Kyung Hwa Kim, Ja Hong Kuh, Tae Yun Kim, Jong Bum Choi
Department of Thoracic and Cardiovascular Surgery, Chonbuk National University Hospital, Chonbuk National University College of Medicine, Jeollabuk-do, Korea
- 094 **Early Clinical Outcomes of Tricuspid Valve Repair with Tri-Ad Annuloplasty Ring; Is it better or Worse than MC3 Ring?**
Woohyun Jung, Jae-Woong Choi, Ho Young Hwang, Kyung Hwan Kim
Department of Thoracic and Cardiovascular Surgery, Seoul National University Hospital, Seoul National University College of Medicine, Seoul, Korea
- 095 **Long-term Outcome of Maze Procedure Combined with Endoatriectomy Performed in Calcified Left Atrium**
Yochun Jung, Gwan Sic Kim, Kyo Seon Lee, In Seok Jeong, Sang Gi Oh, Kook Joo Na, Byoung Hee Ahn
Department of Thoracic and Cardiovascular Surgery, Chonnam National University Hospital, Chonnam National University College of Medicine, Gwangju, Korea



09:15 ~ 10:30 **기초/최소침습/외상 (96 ~ 101 연제)** **좌장: 임상현, 임 청**

- 096 **Outcomes of Robotic Assisted Surgical Ablation of Atrial Fibrillation Combined with Mitral Valve Surgery**
 Chee-hoon Lee, Min Ho Ju, Joon Bum Kim, Jae Won Lee
Department of Thoracic and Cardiovascular Surgery, Asan Medical Center, Ulsan University College of Medicine, Seoul, Korea
- 097 **Clinical Values of Minimally Invasive Mitral Valve Surgery in the Elderly Population**
 Hyung Gon Je, Mi Hee Lim, Sang-Kwon Lee, Ji Hye Lee, Hye Rim Oh
Department of Cardiovascular and Thoracic Surgery, Pusan National University Yangsan Hospital, Pusan National University College of Medicine, Gyeongsangnam-do, Korea
- 098 **Clinical Result of Arteriovenous Fistulae using Autologous Vessel in end Stage Renal Disease Patients on Hemodialysis**
 Ki Tae Kim, Jae Wook Ryu, Pil Won Seo, Keoung Min Ryu
Department of Thoracic and Cardiovascular Surgery, Dankook University Hospital, Dankook University College of Medicine, Chungcheongnam-do, Korea
- 099 **Effect of C-reactive Protein Deposition on Myocardial Area at Risk: Novel Insight from Global MicroRNA Profiling in Ischemia-reperfusion Injury Rat Model**
 Se Jin Oh¹, Eun Na Kim², ChongJai Kim², Ki-Bong Kim³, Han Seok Choe⁴, Yun-Yong Park⁴
¹*Department of Thoracic and Cardiovascular Surgery, SMG-SNU Boramae Medical Center, Seoul National University College of Medicine, Seoul,* ²*Department of Pathology, Asan Medical Center, Ulsan University College of Medicine, Seoul,* ³*Department of Thoracic and Cardiovascular Surgery, Seoul National University Hospital, Seoul National University College of Medicine, Seoul,* ⁴*Asan Institute for Life Science, Asan Medical Center, Ulsan University College of Medicine, Seoul, Korea*
- 100 **Effect of Different washing Methods on the Decellularization Process Based on Sodium Dodecyl Sulfate for Porcine Pulmonary Artery Wall**
 Hyungtae Kim, Si Chan Sung, Kwang Ho Choi, Young Suk Kim
Department of Thoracic and Cardiovascular Surgery, Pusan National University Yangsan Hospital, Pusan National University College of Medicine, Gyeongsangnam-do, Korea
- 101 **Cardiopulmonary Bypass Preparation before Surgical Exploration for Traumatic Cardiac Injury: Overuse or Necessity?**
 Seong Cheol Jeong, Insub Kim, Jae Jun Kim, Si Young Choi, Yong Hwan Kim
Department of Thoracic and Cardiovascular Surgery, Uijeongbu St. Mary's Hospital, The Catholic University College of Medicine, Gyeonggi-do, Korea

10:30 ~ 11:00 *Coffee Break*



08:00~09:15

최소침습 II (102~106 연제)

좌장: 김동원, 김영대

- 102 **High-end Pectus Surgery: Total Chest Wall Remodeling for Pectus Excavatum, Carinatum, and Mixed Deformities**
 Kyung Soo Kim, Mi Hyoung Moon, Young Kyu Moon, Seok Beom Hong, Min Namkoong, Hyo Chan An, Hyung Joo Park
Department of Thoracic and Cardiovascular Surgery, Seoul St. Mary's Hospital, The Catholic University College of Medicine, Seoul, Korea
- 103 **Management of Loculated Pleural Effusion: Surgical vs Non-surgical**
 YongJin Chang, DeogGon Cho, KyuDo Cho, ChulUng Kang, MinSeop Cho
Departments of Thoracic and Cardiovascular Surgery, St. Vincent`s Hospital, The Catholic University College of Medicine, Gyeonggi-do, Korea
- 104 **Long-term Outcomes of Radiographically Noninvasive Adenocarcinoma of the Lung According to the Surgical Strategy: Video-assisted Thoracoscopic Surgery (VATS) Lobectomy Versus VATS Sublobar Resection**
 Jae Kwang Yun, Min Kyun Kang, Geun Dong Lee, Byung Kwon Chong, Han Pil Lee, Se Hoon Choi, Hyeong Ryul Kim, Yong-Hee Kim, Dong Kwan Kim, Seung-Il Park
Department of Thoracic and Cardiovascular Surgery, Asan Medical Center, Ulsan University College of Medicine, Seoul, Korea
- 105 **Polyglycolic Acid (PGA) Sheet with Fibrin Glue Technique in Single Port VATS for Primary Spontaneous Pneumothorax**
 Kyung Soo Kim, June Lee, Seha Ahn, Jin Won Shin, Jung Seok Choi, Ji Yun Lee
Department of Thoracic and Cardiovascular Surgery, Seoul St. Mary's Hospital, The Catholic University College of Medicine, Seoul, Korea
- 106 **Electromagnetic Navigation Bronchoscopy-guided localization for Thoracoscopic Resection of Pulmonary Nodules**
 Hyun Jin Cho, Woo Sik Han, Shin Kwang Kang, Jae Hyeon Yu, Myung Hoon Na, Sung Joon Han, Min-Woong Kang
Department of Thoracic and Cardiovascular Surgery, Chungnam National University Hospital, Chungnam National University College of Medicine, Daejeon, Korea



09:15~10:30

폐암 III (107~112 연제)

좌장: 이종목, 김홍관

- 107 **Clinical Outcomes of Pulmonary Resection for Non-small Cell Lung Cancer with Pleural Seeding Incidentally Detected during Surgery**
 Jae Kwang Yun, Min Kyun Kang, Hyeong Ryul Kim, Byung Kwon Chong, Han Pil Lee, Geun Dong Lee, Se Hoon Choi, Yong-Hee Kim, Dong Kwan Kim, Seung-il Park
Department of Thoracic and Cardiovascular Surgery, Asan Medical Center, Ulsan University College of Medicine, Seoul, Korea
- 108 **The Association Between Cigarette Smoking and Histologic Subtypes in Resected Lung Adenocarcinoma**
 Jung Hoon Yi, Pil Jo Choi, Sang Seok Jeong, Joo Hyun Cho
Department of Thoracic and Cardiovascular Surgery, Dong-A University Hospital, Dong-A University College of Medicine, Busan, Korea
- 109 **Lymph Node Involvement and Survival of Pathologic Predominant Subtype in Clinical Stage I Invasive Adenocarcinoma using Forthcoming 8th Staging System**
 Chi Hoon Bae, Tae Hong Yoon, Ki Sung Park
Department of Thoracic and Cardiovascular Surgery, Daegu Catholic University Medical Center, Daegu Catholic University College of Medicine, Daegu, Korea
- 110 **Treatment Response and Survival Outcomes are Associated with Histologic Type in Non-small Cell Lung Cancer Treated with Trimodal Treatment**
 Tae Hee Hong¹, Hong Kwan Kim¹, Sumin Shin¹, Jong Ho Cho¹, Yong Soo Choi¹, Jae Ill Zo¹, Young Mog Shim¹, Keunchil Park², Myung-Ju Ahn², Jin Seok Ahn², Se-Hoon Lee², Jong-Mu Sun², Yong Chan Ahn³, Hong Ryull Pyo³, Jae Myoung Noh³, Joungho Han⁴, Jhingook Kim¹
¹Department of Thoracic and Cardiovascular Surgery, ²Division of Hematology-Oncology, Department of Medicine, ³Department of Radiation Oncology, ⁴Department of Pathology, Samsung Medical Center, Sungkyunkwan University School of Medicine, Seoul, Korea
- 111 **Analysis of Impact of Interstitial Lung Disease on Patient who Underwent Pulmonary Resection for Lung Cancer**
 Kyoung Shik Narm, Jee Won Suh, Seong Yong Park, Dae Joon Kim, Kyung Young Chung, Jin Gu Lee
Department of Thoracic and Cardiovascular Surgery, Severance Hospital, Yonsei University College of Medicine, Seoul, Korea
- 112 **Recent Outcomes of Surgical Resection followed by Postoperative Adjuvant Therapy for Non-small Cell Lung Cancer with N2 Disease**
 Jin San Bok, Dong Kwan Kim, Hyeong Ryul Kim, Yong-Hee Kim, Seung-il Park, Se-Hoon Choi
Department of Thoracic and Cardiovascular Surgery, Asan Medical Center, Ulsan University College of Medicine, Seoul, Korea

10:30~11:00 Coffee Break



09:15~10:30

일반흉부 II (113~118 연제)

좌장: 이성호, 김재범

- 113 **Miniatured X-ray Fluoroscopic Device for Minimally Invasive Surgery**
 Kook Nam Han¹, Byun Hyun Choi², Hyun Koo Kim¹, Young Ho Choi¹, Jae Sung Lee², Haewook Park²
¹Department of Thoracic and Cardiovascular Surgery, Korea University Guro Hospital, Korea University College of Medicine, Seoul, ²Department of Nuclear Medicine, Seoul National University Hospital, Seoul National University College of Medicine, Seoul, Korea
- 114 **Simulation of Lung Allocation Score (LAS) in a Korean Center and its Implications for the Korean Allocation System**
 Woo Sik Yu¹, Jee Won Suh², Kyoung Shik Narm², Song Yee Kim³, Moo Suk Park³, Hyo Chae Paik², Jin Gu Lee²
¹Department of Thoracic Surgery, Armed Forces Capital Hospital, Gyeonggi-do, ²Department of Thoracic and Cardiovascular Surgery, ³Division of Pulmonology, Department of Internal Medicine, Severance Hospital, Yonsei University College of Medicine, Seoul, Korea
- 115 **Actual Measurement of Pleural Pressure with High-resolution Pleural Manometer: Preliminary Analysis**
 Jin San Bok, Geun-Dong Lee, Dong-kwan Kim, Se-Hoon Choi
 Department of Thoracic and Cardiovascular Surgery, Asan Medical Center, Ulsan University College of Medicine, Seoul, Korea
- 116 **Clinical Outcomes of Lung Transplantation: Experience at a Single Center**
 Se Hoon Choi, Yong Ho Jeong, Min Kyun Kang, Han Pil Lee, Byung Kwon Chong, Jin San Bok, Geun Dong Lee, Hyeong Ryul Kim, Yong-Hee Kim, Dong Kwan Kim, Seung-Il Park
 Department of Thoracic and Cardiovascular Surgery, Asan Medical Center, Ulsan University College of Medicine, Seoul, Korea
 지정토론: 백효채(연세대학교 신촌세브란스병원)
- 117 **Management of Chyle Leakage after General Thoracic Surgery: Impact of Thoracic Duct Embolization**
 Dong Woog Yoon, Jong Ho Cho, Sumin Shin, Hong Kwan Kim, Yong Soo Choi, Jhingook Kim, Jae Ill Zo, Young Mog Shim
 Department of Thoracic and Cardiovascular Surgery, Samsung Medical Center, Sungkyunkwan University School of Medicine, Seoul, Korea
- 118 **Outcomes of Lung Resection in Neonates with Symptomatic Congenital Lung Anomalies**
 Byung Kwon Chong, Min-Kyun Kang, Han Pil Lee, Jin San Boka, Geun Dong Leea, Se Hoon Choi, Hyeong Ryul Kim, Yong-Hee Kim, Seung Il Park, Dong Kwan Kim
 Department of Thoracic and Cardiovascular Surgery, Asan Medical Center, Ulsan University College of Medicine, Seoul, Korea

10:30~11:00 Coffee Break

English Competition Forum



둘째날 2017. 11. 6(일)

장소: 크리스탈 볼룸 1+2

15:30~16:30

English Competition Forum I (1~8 연제)

좌장: 이 삭, 황호영

- E 01 **Initial Experience of Edwards Intuity Elite Rapid Deployment Aortic Valve Replacement**
Sue Hyun Kim, Hak Ju kim, Jae Woong Choi, Kyung Hwan Kim
Department of Thoracic and Cardiovascular Surgery, Seoul National University Hospital, Seoul National University College of Medicine, Seoul, Korea
- E 02 **Short Inverted Graft Anastomosis for Proximal Aortic Repair in Acute Type A Aortic Dissection: Technique and Surgical Experiences**
Seung Ri Kang, Joon Bum Kim
Department of Thoracic and Cardiovascular Surgery, Asan Medical Center, Ulsan University College of Medicine, Seoul, Korea
- E 03 **Fate of Malperfused Kidney in Acute DeBakey Type I Aortic Dissection**
Shin-Young Lee¹, Woon Heo¹, Suk-Won Song¹, Tae-Hoon Kim¹, Min-Young Baek¹, Kyung-Jong Yoo², Bum-Koo Cho³
¹Department of Thoracic and Cardiovascular Surgery, Gangnam Severance Hospital, Yonsei University College of Medicine, Seoul, ²Department of Thoracic and Cardiovascular Surgery, Severance Hospital, Yonsei University College of Medicine, The Korea Heart Foundation, Seoul, ³The Korea Heart Foundation, Seoul, Korea
- E 04 **Outcomes of Coronary Artery Bypass Graft after Extracorporeal Life Support in Patients with Ischemic Heart Disease Complicated with Refractory Cardiogenic Shock: A Single Center Experiences**
Young Hwan Kim, Hee Moon Lee, Yang Hyun Cho, Dong Seop Jeong, Kiick Sung, Pyo Won Park, Young Tak Lee, Wook Sung Kim
Department of Thoracic and Cardiovascular Surgery, Samsung Medical Center, Sungkyunkwan University School of Medicine, Seoul, Korea
- E 05 **Follow Up Outcome of Endoscopic Vein Harvest in Coronary Artery Bypass Surgery**
June Lee, Hyun Song, Joonkyu Kang
Departments of Thoracic and Cardiovascular Surgery, Seoul St. Mary's Hospital, The Catholic University College of Medicine, Seoul, Korea
- E 06 **Surgical Experience of Massive Pulmonary Thromboembolism for 14 Years**
Jiye Park¹, Jonghwan Moon², You Sun Hong¹, Sang-hyun Lim¹
¹Department of Thoracic and Cardiovascular Surgery, Ajou University Hospital, Ajou University School of Medicine, Gyeonggi-do, ²Division of Trauma Surgery, Department of Surgery, Ajou University Hospital, Ajou University School of Medicine, Gyeonggi-do, Korea
- E 07 **Negative Pressure Wound Therapy for the Opened Wound following Partial Excision of the Infected Arteriovenous Graft**
So Young Bae¹, Seunghyuk Nam², Sun Kyun Ro²
¹Department of Thoracic and Cardiovascular Surgery, Hanyang University Guri Hospital, Hanyang University College of Medicine, Gyeonggi-do, ²Department of Thoracic and Cardiovascular Surgery, Hanyang University Medical Center, Hanyang University College of Medicine, Seoul, Korea
- E 08 **Case Series: ECMO during MERS-CoV Outbreak**
Min Soo Kim, You Jin Ha, Young Hwan Kim, Yong Chae Jung, Ji Hyuk Yang, Kiick Sung, Yang Hyun Cho
Department of Thoracic and Cardiovascular Surgery, Samsung Medical Center, Sungkyunkwan University School of Medicine, Seoul, Korea



15:30~16:30

English Competition Forum II (9~16 연제)

좌장: 함석진, 강민웅

- E 09 Endoscopic Vacuum-assisted Closure Therapy in Patients with Anastomotic Leakage after Esophagectomy: A Single Center Experience**
Zeead AlGhamdi³, Soo Min Noh¹, Ji Yong Ahn², Jeong Hoon Lee², Hwoon-Yong Jung², Hyeong Ryul Kim³, Yong-Hee Kim³
¹Department of Internal Medicine, Asan Digestive Disease Research Institute, ²Department of Gastroenterology, Asan Digestive Disease Research Institute, ³Department of Thoracic and Cardiovascular Surgery, Asan Medical Center, Ulsan University College of Medicine, Seoul, Korea
- E 10 Single-port Video Assisted Thoracoscopic Surgery on Reoperated Surgery**
Jun Hee Lee, Hyun Koo Kim, Young Ho Choi, Kook Nam Han, Kang Hoon Lee
 Department of Thoracic and Cardiovascular Surgery, Korea University Anam Hospital, Korea University College of Medicine, Seoul, Korea
- E 11 Comparison of Recurrence Pattern: Sublobar Resection Versus Lobectomy for Staging I Non-small Cell Lung Cancer**
Ha Eun Kim, Jin Gu Lee
 Department of Thoracic and Cardiovascular Surgery, Severance Hospital, Yonsei University College of Medicine, Seoul, Korea
- E 12 Prognosis of younger Patients in Non-small Cell Lung Cancer**
Sira Laohathai, Hyo Jun Jang, Yong Won Sung, Kwhanmien Kim, Sanghoon Jheon, Sukki Cho
 Department of Thoracic and Cardiovascular Surgery, Seoul National University Bundang Hospital, Seoul National University College of Medicine, Gyeonggi-do, Korea
- E 13 Comparison between Sublobar and Lobar Resection in Octogenarians with Pathologic Stage I Non-small Cell Lung Cancer**
Sira Laohathai, Hyo Jun Jang, Yong Won Song, Kwhanmien Kim, Sanghoon Jheon, Sukki Cho
 Department of Thoracic and Cardiovascular Surgery, Seoul National University Bundang Hospital, Seoul National University College of Medicine, Gyeonggi-do, Korea
- E 14 Pulmonary Segmentectomy in Children: An Analysis of the Surgical Outcomes of 44 Cases**
Yoonjin Kang, Kwan Yong Hyun, Samina Park, Hyun-Ju Lee, In kyu Park, Young Tae Kim, Chang Hyun Kang
 Department of Thoracic and Cardiovascular Surgery, Seoul National University Hospital, Seoul National University College of Medicine, Seoul, Korea
- E 15 Clinical Outcomes of Neoadjuvant Treatment in Advanced Esophageal Cancer**
Woohyun Jung, Kwanyoung Hyun, Saemina Park, In Kyu Park, Young Tae Kim, Chang Hyun Kang
 Department of Thoracic and Cardiovascular Surgery, Seoul National University Hospital, Seoul National University College of Medicine, Seoul, Korea
- E 16 Surgical Outcomes of VATS Pulmonary Stapled Segmentectomy**
JiYun Lee, YongJin Chang, DeogGon Cho, KyuDo Cho, ChulUng Kang, MinSeop Cho
 Departments of Thoracic and Cardiovascular Surgery, St. Vincent's Hospital, The Catholic University College of Medicine, Gyeonggi-do, Korea



15:30~16:30

English Competition Forum III (17~22 연제)

좌장: 유재현, 이 철

- E 17 **Prevention of Limb Ischemia in Children with VA ECMO through Femoral Artery**
Jeong-hee Yun, Ji-Hyuk Yang, Tae-Gook Jun, Yang Hyun Cho, Kiick Sung, Young Tak Lee
Departments of Thoracic and Cardiovascular Surgery, Samsung Medical Center, Sungkyunkwan University School of Medicine, Seoul, Korea
- E 18 **Impact of Ventricular Morphology on Clinical Outcome after the Fontan Palliation**
WonKyung Pyo, EunSeok Choi, TaeJin Yun
Department of Thoracic and Cardiovascular Surgery, Asan Medical Center, Ulsan University College of Medicine, Seoul, Korea
- E 19 **Early Surgical Closure of Patent Ductus Arteriosus in Preterm Neonates**
Yoonjin Kang, Jae Gun Kwak, Eungrae Kim, Jeong Ryeol Lee, Woong-Han Kim
Department of Thoracic & Cardiovascular Surgery, Seoul National University Children's Hospital, Seoul National University College of Medicine, Seoul, Korea
- E 20 **Novel Surgical Technique for the Prevention of Pulmonary Arteriovenous Malformations in Left Isomerism**
Won Young Lee, Eun Seok Choi, Chun Soo Park, Tae-Jin Yun
Department of Thoracic and Cardiovascular Surgery, Asan Medical Center, Ulsan University College of Medicine, Seoul, Korea
- E 21 **Outcomes of Surgical Intervention for Infective Endocarditis in Pediatric Patients**
Won Kyoung Park, Tae-Jin Yun, Eun Seok Choi, Chun Soo Park
Department of Pediatric Cardiac Surgery, Asan Medical Center, Ulsan University College of Medicine, Seoul, Korea
- E 22 **Reoperations after Repair of Complete Atrioventricular Septal Defect: A 20-year Single-center Experience**
Bongyeon Sohn, Jae Gun Kwak, Eung Re Kim, Jae Hong Lim, Jooncheol Min, Woong-Han Kim
Department of Thoracic and Cardiovascular Surgery, Seoul National University Hospital, Seoul National University College of Medicine, Seoul, Korea



셋째날 2017. 11. 7(화)

장소: 크리스탈 볼룸 1+2

13:30~15:00

포럼 I (1~11 연제)

좌장: 정재승, 이승현

- F 01 The Optimal Criteria of Tricuspid Annuloplasty for the Patients with Less than Moderate Functional TR**
Jae Woong Choi, Ho Young Hwang, Kyung Hwan Kim
Department of Thoracic and Cardiovascular Surgery, Seoul National University Hospital, Seoul National University College of Medicine, Seoul, Korea
- F 02 Early Outcomes of Nonresectional folding Mitral Valvuloplasty for Posterior Mitral Leaflet Prolapse**
 Yong Han Kim, June Lee, Keon Hyun Jo, Hwan Wook Kim
Department of Thoracic and Cardiovascular Surgery, Seoul St. Mary's Hospital, The Catholic University College of Medicine, Seoul, Korea
- F 03 Long-term Results of Tricuspid Annuloplasty using the MC3 Ring for Functional Tricuspid Regurgitation**
Jae Woong Choi, Sue Hyun Kim, Sang Yoon Yeom, Ho Young Hwang, Ki-Bong Kim, Kyung Hwan Kim
Department of Thoracic and Cardiovascular Surgery, Seoul National University Hospital, Seoul National University College of Medicine, Seoul, Korea
- F 04 Simple Interrupted Suturing for Aortic Valve Replacement in Patient with Severe Aortic Stenosis**
Chee-hoon Lee, Min Ho Ju, Joon Bum Kim, Sung-Ho Jung, Suk Jung Choo, Cheol Hyun Chung, Jae Won Lee
Department of Thoracic and Cardiovascular Surgery, Asan Medical Center, Ulsan University College of Medicine, Seoul, Korea
- F 05 Outcomes of Reoperative Valve Replacement in Patients with Prosthetic Valve Endocarditis: A 20-year Experience**
Young Woong Kim, Ho Jin Kim, Sung-Ho Jung, Suk Jung Choo, Cheol Hyun Chung, Jae Won Lee, Joon Bum Kim
Department of Thoracic and Cardiovascular Surgery, Asan Medical Center, Ulsan University College of Medicine, Seoul, Korea
- F 06 Clinical Outcome and Cost Analysis of Rapid Deployment Aortic Valve Replacement Versus Transcatheter Aortic Valve Implantation: A Single Center Early Experience**
Mi Hee Lim, Hyung Gon Je, Sang-Kwon Lee, Ji Hye Lee, Hye Rim Oh
Department of Cardiovascular and Thoracic Surgery, Pusan National University Yangsan Hospital, Pusan National University College of Medicine, Gyeongsangnam-do, Korea
- F 07 The Role of Partial Arch Repair in Acute Type I Aortic Dissection Presented with Stroke**
Won Gi Woo¹, Suk-Won Song¹, Woon Heo¹, Tae Hoon Kim¹, Yoo-Jeong Lee¹, Kyung-Jong Yoo², Bum-Koo Cho³
¹*Department of Thoracic and Cardiovascular Surgery, Gangnam Severance Hospital, Yonsei University College of Medicine, Seoul,* ²*Department of Thoracic and Cardiovascular Surgery, Severance Hospital, Yonsei University College of Medicine, Seoul,* ³*The Korea Heart Foundation, Seoul, Korea*
- F 08 Risk Factors of Reintervention after Thoracic Endovascular Aortic Repair for Descending Aortic Pathologies**
Young Eun Kim, Jeong-Won Kim, Shin-Ah Son, Jong Tae Lee, Gun Jik Kim
Department of Thoracic and Cardiovascular Surgery, Kyungpook National University Hospital, Kyungpook National University College of Medicine, Daegu, Korea



- F 09 **Effect of Total Arterial Revascularization on Long-term Clinical Outcomes in Off-pump Coronary Artery Bypass; at 10 Years Follow-up**
Do Jung Kim, Hyun-Chel Joo, Seung Hyun Lee, Kyung-Jong Yoo, Young-Nam Youn
Department of Cardiovascular Surgery, Severance Cardiovascular Hospital, Yonsei University College of Medicine, Seoul, Korea
- F 10 **The Effect of Human Thymus Fat-derived Mesenchymal Stem Cell on Myocardial Infarcted Rat Model**
Jun Woo Cho¹, Jae Seok Jang², Oh Choon Kwon²
¹*Department of Thoracic and Cardiovascular Surgery, Asan Medical Center; Ulsan University College of Medicine, Seoul,* ²*Department of Thoracic and Cardiovascular Surgery, Daegu Catholic University Medical Center, Daegu Catholic University College of Medicine, Daegu, Korea*
- F 11 **Experience of Extracorporeal Right Ventricular Assist Device with or without Oxygenator: Case Series**
Il Kun Park, Jun Ho Lee, Young Soo Kim, Chang Seok Jeon, Yang Hyun Cho, Ji Hyuk Yang, Ki Ick Sung, Young Tak Lee
Department of Thoracic and Cardiovascular Surgery, Samsung Medical Center; Sungkyunkwan University School of Medicine, Seoul, Korea



13:30~15:00

포럼 II (12~20 연제)

좌장: 이호석, 최용수

- F 12 How does the Pectus Bar Affect Thoracic Cage Dynamics during Respiratory Movements?**
Seok Beom Hong, Mi-Hyoung Moon, Kyung Soo Kim, Young Kyu Moon, Min Namkoong, Hyo Chan An, Hyung Joo Park
Department of Thoracic and Cardiovascular Surgery, Seoul St. Mary's Hospital, The Catholic University College of Medicine, Seoul, Korea
- F 13 Simultaneous Surgery of Concomitant Malignant Disease in the Esophagus and Lung**
Jae Jun Jung, Sumin shin, Jong Ho Cho, Hong Kwan Kim, Yong Soo Choi, Jhingook Kim, Jae Ill Zo, Young Mog Shim
Department of Thoracic and Cardiovascular Surgery, Samsung Medical Center, Sungkyunkwan University School of Medicine, Seoul, Korea
- F 14 Non-intubated VATS Wedge Resection for Pneumothorax**
 Jae Hoon Lee, Eui Suk Chung, Sung Joon Park
Department of Thoracic and Cardiovascular Surgery, Inje University Sanggye Paik Hospital, Inje University College of Medicine, Seoul, Korea
- F 15 Uniportal VATS Surgery without Endotracheal Intubation: Single Center Experience**
Seha Ahn, Youngkyu Moon, Sook Whan Sung
Department of Thoracic and Cardiovascular Surgery, Seoul St. Mary's Hospital, The Catholic University College of Medicine, Seoul, Korea
- F 16 Detailed Prognostic Impact of Lymphovascular Invasion in Resected Lung Adenocarcinoma**
Jung Hoon Yi, Pil Jo Choi, Sang Seok Jeong, Joo Hyun Cho
Department of Thoracic and Cardiovascular Surgery, Dong-A University Hospital, Dong-A University College of Medicine, Busan, Korea
- F 17 Initial Experiences of Robotic Lobectomy for Lung Cancer**
Seha Ahn, Jin Yong Jeong
Department of Thoracic and Cardiovascular Surgery, Incheon St. Mary's Hospital, The Catholic University College of Medicine, Incheon, Korea
- F 18 Cervical Drain Amylase Level as a Predictor of Anastomotic Leakage after Esophagectomy**
Joonho Jung, Seokjin Haam, Sang Hyun Lim, You Sun Hong, Cheol Joo Lee, Jiye Park
Department of Thoracic and Cardiovascular Surgery, Ajou University Hospital, Ajou University School of Medicine, Gyeonggi-do, Korea
- F 19 Abdominal Versus Thoracic Approach for Epiphrenic Esophageal Diverticulum: Which is Better?**
Shin Kim, Jong Ho Cho, Hong Kwan Kim, Yong Soo Choi, Jhingook Kim, Jae Ill Zo, Young Mog Shim
Department of Thoracic and Cardiovascular Surgery, Samsung Medical Center, Sungkyunkwan University School of Medicine, Seoul, Korea
- F 20 Various Applications of Intraoperative High Resolution Cone Beam CT in the Thoracic Surgery**
 Bong Soo Son, Hee Je Sim, Jong Myung Park, Do Hyung Kim
Department of Thoracic and Cardiovascular Surgery, Pusan National University Yangsan Hospital, Pusan National University College of Medicine, Gyeongsangnam-do, Korea



13:30~15:00

포럼 <성인> III (21~26 연제)

좌장: 오상기, 김근직

- F 21 **Outcome in Patients of Cardiopulmonary Collapse Having Salvage Coronary Artery Bypass Grafting with using Extracorporeal Membrane Oxygenation**
Soojin Park, Ji Ye Park, Joonho Jung, You Sun Hong, Cheol Joo Lee, Sang-Hyun Lim
Department of Thoracic and Cardiovascular Surgery, Ajou University Hospital, Ajou University School of Medicine, Gyeonggi-do, Korea
- F 22 **Effects of Preoperative Autologous Blood Donation in Patients Undergoing Open Heart Surgery**
 Hyung Gon Je¹, Mi Hee Lim¹, Sang-Kwon Lee¹, Ji Hye Lee², Hye Lim Oh²
¹*Department of Cardiovascular and Thoracic Surgery, ²Research Institute for Convergence of Biomedical Science and Technology, Pusan National University Yangsan Hospital, Pusan National University College of Medicine, Gyeongsangnam-do, Korea*
- F 23 **A 10-year Experience of Ring Annuloplasty and Chordal Replacement without Leaflet Resection in Mitral Valve Repair**
Yang Gi Ryu, Man-Jong Baek
Department of Thoracic and cardiovascular Surgery, Korea University Guro Hospital, Korea University College of Medicine, Seoul, Korea
- F 24 **Surgical Outcome of Native Valve Endocarditis**
Bong Suk Park, Weon Yong Lee
Department of Thoracic and Cardiovascular Surgery, Sacred Heart Hospital, Hanlym University College of Medicine, Gyeonggi-do, Korea
- F 25 **Preoperative Hemodynamic Status and Outcomes of Surgery for Acute Type A Aortic Dissection**
 Jong Bum Choi, Jong Hun Kim, Tae Yun Kim, Joon Young Song, Ja Hong Kuh
Department of Thoracic and Cardiovascular Surgery, Chonbuk National University Hospital, Chonbuk National University College of Medicine, Jeollabuk-do, Korea
- F 26 **Thoracic Endovascular Aortic Repair (TEVAR) for Complicated Type B Aortic Dissection**
Hong Chul Oh, Young Woo Park, Won Ho Chang
Department of Thoracic and Cardiovascular Surgery, Soonchunhyang University Hospital Seoul, Soonchunhyang University College of Medicine, Seoul, Korea



08:00~09:15

포럼 <일반홍부> IV (27~36 연제)

좌장: 이해원, 조석기

- F 27 **Feasibility and Safety of Total Meso-esophageal Dissection in Esophageal Cancer**
 Jee Won Suh, Seong Yong Park, Go Eun Byun, Kyoung Sik Narm, Chang Young Lee, Jin Gu Lee, Hyo Chae Paik, Kyoung Young Chung, Dae Joon Kim
Department of Thoracic and Cardiovascular Surgery, Severance Hospital, Yonsei University College of Medicine, Seoul, Korea
- F 28 **The Change of Post-esophagectomy Nutritional Status after Combined Enteral Feeding through Jejunostomy**
 Young Ran Kim¹, Dal Lae Ju¹, Misun Park¹, Kwan Yong Hyun², Samina Park², In Kyu Park², Young Tae Kim², Chang Hyun Kang²
¹Department of Food Service and Nutrition Care, ²Department of Thoracic and Cardiovascular Surgery, Seoul National University Hospital, Seoul National University College of Medicine, Seoul, Korea
- F 29 **Survival and Postoperative Outcomes after Lung Transplantation in Connective Tissue Related Interstitial Lung Disease**
 Jee Won Suh¹, Jin Gu Lee¹, Kyoung Sik Narm¹, Sujin Jung², Moo Suk Park³, Song Yee Kim³, Joo Han Song³, Hyo Chae Paik¹
¹Department of Thoracic and Cardiovascular Surgery, ²Department of Internal Medicine-Infection, ³Department of Internal Medicine-Pulmonary, Severance Hospital, Yonsei University College of Medicine, Seoul, Korea
- F 30 **Is Really Thoracic Sonography Useful in Detection of Traumatic Pneumothorax?**
 Chun Sung Byun, Chang Wan Kim, Kwan Wook Kim, Soonchang Hong, Joong Hwan Oh
Department of Thoracic and Cardiovascular Surgery, Severance Hospital, Yonsei University College of Medicine, Seoul, Korea
- F 31 **Surgical Outcomes of Small Cell Lung Cancer Patients - Comparison with Pure Small Cell Lung Cancer Versus Mixed or Synchronous Small Cell Lung Cancer**
 Han Pil Lee, Min Kyun Kang, Byung Kwon Chong, Jin San Bok, Geun Dong Lee, Se Hoon Choi, Hyeong Ryul Kim, Yong-Hee Kim, Seung Il Park, Dong Kwan Kim
Department of Thoracic & Cardiovascular Surgery, Asan Medical Center, Ulsan University College of Medicine, Seoul, Korea
- F 32 **Surgery for Hemoptysis in Patients with Benign Lung Disease**
 Ju Sik Yun¹, Sang Yun Song¹, Gwan Sic Kim², Kyo Seon Lee², Do Wan Kim², Yochun Jung², In Seok Jeong², Bong-Suk Oh², Byoung Hee Ahn², Seok Kim¹, Kook Joo Na¹
¹Department of Thoracic and Cardiovascular Surgery, Chonnam National University Hwasun Hospital, Chonnam National University College of Medicine, Jeollanam-do, ²Department of Thoracic and Cardiovascular Surgery, Chonnam National University Hospital, Chonnam National University College of Medicine, Gwangju, Korea
- F 33 **Single Incision Video-assisted Thoracoscopic Wedge Pulmonary Resection: Four Years of Experience**
 Ju Sik Yun¹, Kook Joo Na¹, Gwan Sic Kim², Kyo Seon Lee², Do Wan Kim², Yochun Jung², In Seok Jeong², Bong-Suk Oh², Byoung Hee Ahn², Seok Kim¹, Sang Yun Song¹
¹Department of Thoracic and Cardiovascular Surgery, Chonnam National University Hwasun Hospital, Chonnam National University College of Medicine, Jeollanam-do, ²Department of Thoracic and Cardiovascular Surgery, Chonnam National University Hospital, Chonnam National University College of Medicine, Gwangju, Korea
- F 34 **Clinical Correlation between Recurrence Rate of Primary Spontaneous Pneumothorax and Presence of Bullae in Chest Computed Tomography in the First Episode of Pneumothorax**
 Byung Mo Gu, Bong Suk Park, Hong Kyu Lee, Hyoung Soo Kim, Weon Yong Lee, Yong Joon Ra
Department of Thoracic and Cardiovascular Surgery, Sacred Heart Hospital, Hanlym University College of Medicine, Gyeonggi-do, Korea



- F 35 **The Feasibility of One Stage Combined Thoracic and Abdominal Surgery using Minimal Invasive Thoracic Approach**
Sim Hee Je, Jong Myung Park, Bong Soo Son, Do Hyung Kim
Department of Thoracic and Cardiovascular Surgery, Pusan National University Yangsan Hospital, Pusan National University College of Medicine, Gyeongsangnam-do, Korea
- F 36 **The Efficacy and Safety of CT Guided Localization with Hook Wire Prior to VATS**
Ji Seong Lee, Jae Bum Park, Song Am Lee, Jae Joon Hwang
Department of Thoracic and Cardiovascular Surgery, Konkuk University Medical Center, Konkuk University School of Medicine, Seoul, Korea

E-Poster Presentations



일시: 2017. 11. 6(월)~8(수)

장소: 크리스탈 볼룸 로비

- 01 Predictive Risk Factors of Acute Kidney Injury after Coronary Artery Bypass Surgery under Cardiopulmonary Bypass**
Jin Tae Kwon¹, Tae Eun Jung², Jun Young Do³, Dong Hyup Lee²
¹Department of Chest Surgery, Bundang Jesaeng Hospital, Gyeonggi-do, ²Department of Thoracic and Cardiovascular Surgery, Yeungnam University Medical Center, Yeungnam University College of Medicine, Daegu, ³Division of Nephrology, Department of Internal Medicine, Yeungnam University Medical Center, Yeungnam University College of Medicine, Daegu, Korea
- 02 The Initial Warfarin dose after Valve Replacement was Larger than Estimated dose by Pharmacogenetic-guided Algorithms**
So Young Lee, Seok In Lee, Chang Hyu Choi, Chul Hyun Park, Kook Yang Park, Jae-Ilk Lee, Kun Woo Kim, Kuk Hui Son
Department of Thoracic and Cardiovascular Surgery, Gachon University Gil Medical Center, Gachon University College of Medicine, Incheon, Korea
- 03 Migration of Lung Cancer Cells in a 3D Environment with Simulated Microgravity**
Chi Bum Ahn¹, Dae Geun Han¹, Jin Woo Lee¹, Chang Hu Choi², Chul Hyun Park², Kook Yang Park², Kuk Hui Son²
¹Department of Molecular Medicine, Gachon University Gil Medical Center, Gachon University Graduate School of Medicine, Incheon, ²Department of Thoracic and Cardiovascular Surgery, Gachon University Gil Medical Center, Gachon University College of Medicine, Incheon, Korea
- 04 RAGE-specific Antagonist Alleviates Elastase-induced Emphysema Development by Preventing RAGE-DAMP Signaling**
Hanbyeol Lee², Soojin Jang², Jooyeon Lee², Woo Jin Kim², Se Min Ryu¹, Sung-Min Park¹, Kyung-Hak Lee¹, Seong-Joon Cho¹, Se-Ran Yang¹
¹Department of Thoracic and Cardiovascular Surgery, ²Department of Internal Medicine, Kangwon National University Hospital, Kangwon National University College of Medicine, Gangwon-do, Korea
- 05 Pulmonary Arterial Intimal Sarcoma with Retrograde Extension**
Yeong Soo Kim, Chang Soo Lee, Sun Nam Kim, Seok Mok Jeong, Kyung-Taek Park, Il-Yong Han, Young Chul Yoon, Yang-Haeng Lee, Jin Hong Wi
Department of Thoracic and Cardiovascular Surgery, Inje University Busan Paik Hospital, Inje University College of Medicine, Busan, Korea
- 06 Risk Factors Associated with Difficult Conversion of Heparin by Protamine during Cardiopulmonary Bypass**
Min Jung Ku, Seogjae Lee, Jee Won Chang, Jonggeun Lee, Su Wan Kim
Department of Thoracic and Cardiovascular Surgery, Jeju National University Hospital, Jeju National University College of Medicine, Jeju, Korea
- 07 Staple Aneurysmorrhaphy to Salvage Arteriovenous Fistula with Aneurysm**
Up Huh, Chung Won Lee, Sang-pil Kim, Seunghwan Song, Miju Bae, Sung Woon Chung
Department of Thoracic and Cardiovascular Surgery, Pusan National University Hospital, Pusan National University College of Medicine, Busan, Korea
- 08 Spontaneous Intercostal Artery Bleeding**
Jong Duk Kim, Dong Hoon Kang, Jae Won Choi, In Seok Jang
Department of Cardio-thoracic Surgery, Gyeongsang National University Hospital, Gyeongsang National University School of Medicine, Gyeongnam, Korea



- 09 **Relationship between Nutritional Status and Prognosis of Chest Blunt Trauma in Elderly Patients**
Chang Wan Kim, Chun Sung Byun, Joong Hwan Oh
Department of Thoracic and Cardiovascular Surgery, Wonju Severance Christian Hospital, Yonsei University College of Medicine, Gangwon-do, Korea
- 10 **Analysis of the Relationship between Recurrence after the Operation of Primary Spontaneous Pneumothorax and the Number of used Stapler**
Joonho Jung, Seokjin Haam, Sang Hyun Lim, You Sun Hong, Cheol Joo Lee, Jiye Park
Department of Thoracic and Cardiovascular Surgery, Ajou University Hospital, Ajou University School of Medicine, Gyeonggi-do, Korea
- 11 **Venous Thoracic Outlet Syndrome (VTOS): A Case Report**
Young Ho Yang, Duk Hwan Moon, Sungsoo Lee
Department of Thoracic Surgery, Gangnam Severance Hospital, Yonsei University College of Medicine, Seoul, Korea
- 12 **Spontaneous Pneumothorax in Tuberculosis Sclerosis Patient**
Won Sang Chung, So Young Bae
Department of Thoracic and Cardiovascular Surgery, Hanyang University Medical Center, Hanyang University College of Medicine, Seoul, Korea
- 13 **Surgical Treatment of Huge Empyema which Makes Total Compression of Ipsilateral Lung Parenchyma and Induces Shifting of Mediastinum Resulting in Cardiopulmonary Dysfunction**
Bongsuk Park, Byungmo Gu, Hyoungsoo Kim, Weonyong Lee, Yongjoon Ra
Department of Thoracic and Cardiovascular Surgery, Sacred Heart Hospital, Hanlym University College of Medicine, Gyeonggi-do, Korea
- 14 **Placement of a Horizontal Running Suture at the Hemostatic Line using Inverted Graft Technique: A Technical Option during Aortic Replacement**
Sun Kyun Ro, Seunghyuk Nam
Department of Thoracic and Cardiovascular Surgery, Hanyang University Guri Hospital, Hanyang University College of Medicine, Gyeonggi-do, Korea
- 15 **Risk Factors of Secondary Intervention for Type II Endoleaks in Endovascular Aneurysm Repair: An 8-year Single Institution Study**
Up Huh, Sung Woon Chung, Sang-pil Kim, Seunghwan Song, Miju Bae, Chung Won Lee
Department of Thoracic and Cardiovascular Surgery, Pusan National University Hospital, Pusan National University College of Medicine, Busan, Korea
- 16 **Fracture of bare Spring Stent Deployed on Aortic Arch after TEVAR**
Shin-Ah Son, Young Eun Kim, Jong Tae Lee, Gun Jik Kim
Department of Thoracic and Cardiovascular Surgery, Kyungpook National University Hospital, Kyungpook National University College of Medicine, Daegu, Korea
- 17 **A Giant Pseudo-aneurysm on Anastomosis Site for Redo Bentall Op due to Bechet's Disease Treated by TEVAR with Hand-made Stent-graft**
Jong Yun Won, Jae Seung Jung, Ho Sung Son, Jeong Uk Han, Jun Hee Lee
Department of Thoracic and Cardiovascular Surgery, Korea University Anam Hospital, Korea University College of Medicine, Seoul, Korea
- 18 **Use of 3D Printing in the Treatment of Aortic Disease**
Jung Suk Choi, Joon Kyu Kang
Department of Thoracic and Cardiovascular Surgery, Seoul St. Mary's Hospital, The Catholic University College of Medicine, Seoul, Korea



- 19 **Delayed Thoracic Endograft Infection with Multiple End-organ Involvement in Uncontrolled Diabetic Patient**
Woo Sung Jang, Jae-Bum Kim, Nam Hee Park
Department of Thoracic and Cardiovascular Surgery, Keimyung University Dongsan Medical Center, Keimyung University School of Medicine, Daegu, Korea
- 20 **Pseudoaneurysm of the Peroneal Artery after Surgical Embolectomy**
Kwan Wook Kim, Chang Wan Kim, Chun Sung Byun, Soonchang Hong, Joong Hwan Oh
Department of Thoracic and Cardiovascular Surgery, Wonju Severance Christian Hospital, Yonsei University College of Medicine, Gangwon-do, Korea
- 21 **Indwelling Duration of Tunnelled Dialysis Catheter in Patients with Autogenous or Prosthetic Arteriovenous Access Formation**
Tae Sik Kim¹, Jin Sung Yang¹, Jung Soo Jo¹, Jae Ho Kim¹, Yun Kyeong Choi¹, Hyang Mo Koo², Mi Jeoung Kim²
¹Department of Thoracic and Cardiovascular Surgery, Hallym General Hospital, Incheon, ²Department of Nephrology, Hallym General Hospital, Incheon, Korea
- 22 **Repair of Late-presenting Interrupted Aortic Arch With Severe Pulmonary Hypertension using a Pulmonary Autograft Tube**
June Lee, Cheul Lee
Department of Thoracic and Cardiovascular Surgery, Seoul St. Mary's Hospital, The Catholic University College of Medicine, Seoul, Korea
- 23 **Ventricular Assist Device is a Feasible Option for Cardiac Support in Patients with Systemic Arterial or Venous Blood as a Major Source for Pulmonary Blood Flow**
Young Hwa Lee, Hye Jin Park, So Yeon Park, Won Kyun Park, Won Young Lee, Chun Soo Park, Tae-Jin Yun
Division of Pediatric Cardiac Surgery, Asan Medical Center, Ulsan University College of Medicine, Seoul, Korea
- 24 **Extracardiac Rupture of a Sinus of Valsalva Aneurysm**
Yeong Soo Kim, Chang Soo Lee, Sun Nam Kim, Seok Mok Jeong, Kyung-Taek Park, Il-Yong Han, Young Chul Yoon, Yang-Haeng Lee, Jin Hong Wi
Department of Thoracic and Cardiovascular Surgery, Inje University Busan Paik Hospital, Inje University College of Medicine, Busan, Korea
- 25 **Successful Treatment using an Endoscopic Endoluminal Vacuum Therapy after Failure of Primary Closure for Boerhaave's Syndrome**
Young Eun Kim, Young Woo Do, Joon Yong Cho, Deok Heon Lee
Department of Thoracic and Cardiovascular Surgery, Kyungpook National University Hospital, Kyungpook National University College of Medicine, Daegu, Korea
- 26 **Clinical Results of Photodynamic Therapy for Inoperable Esophageal Squamous Cell Carcinoma**
Jae Ho Chung, Eunjue Yi, Jun Hee Lee, Kwang Taik Kim, Sungho Lee
Department of Thoracic and Cardiovascular Surgery, Korea University Anam Hospital, Korea University College of Medicine, Seoul, Korea
- 27 **Successful Endovascular Repair of Occlusive Traumatic Aortic Injury: Kissing-stent**
Up Huh, Seon Hee Kim, Sung Woon Chung, Sang-pil Kim, Seunghwan Song, Miju Bae, Chung Won Lee
Department of Thoracic and Cardiovascular Surgery, Pusan National University Hospital, Pusan National University College of Medicine, Busan, Korea
- 28 **Temporary Control of Right Atrial Rupture after Blunt Chest Trauma using Polyglycolic Acid Sheet with Fibrin Glue (TachoComb)**
Se Min Ryu, Sung-Min Park, Kyung-Hak Lee, Seong-Joon Cho, Se-Ran Yang, Jeong-Ran Park, Ki Hwan Kim, Jung Eui Yun, Jin Soo Lee
Department of Thoracic and Cardiovascular Surgery, Kangwon National University Hospital, Kangwon National University College of Medicine, Gangwon-do, Korea



- 29 **Surgical Resection of Huge Cervical Invasive Thymoma after Induction Chemotherapy**
Min Namkoong, Jae Gil Park
Department of Thoracic and Cardiovascular Surgery, Seoul St. Mary's Hospital, The Catholic University College of Medicine, Seoul, Korea
- 30 **The Effect of Energy Device in Video-assisted Thoracic Surgery Lobectomy**
Yoohwa Hwang, Hyeon Jong Moon
Department of Thoracic and Cardiovascular Surgery, SMG-SNU Boramae Medical Center, Seoul National University College of Medicine, Seoul, Korea
- 31 **Modification of Extracorporeal Membrane Oxygenation Configuration according to Patient Status during ECMO Support**
Jung Wook Han, Ho Sung Son, Jae Seung Jung
Department of Thoracic and Cardiovascular Surgery, Korea University Anam Hospital, Korea University College of Medicine, Seoul, Korea
- 32 **Effect of Combined Aortic Regurgitation on the Prognosis in Patients who Underwent Aortic Valve Replacement for Severe Aortic Stenosis: Short Term Echocardiographic Follow Up**
Jung Wook Han, Jae Seung Jung, Ho Sung Son
Department of Thoracic and Cardiovascular Surgery, Korea University Anam Hospital, Korea University College of Medicine, Seoul, Korea
- 33 **Initial Experience on Sutureless Aortic Valve Replacement**
Jae-Bum Kim, Sae Young Choi, Jae Hyun Kim
Department of Thoracic and Cardiovascular Surgery, Keimyung University Dongsan Medical Center, Keimyung University School of Medicine, Daegu, Korea
- 34 **A Case Experience of Mitral Valve Reconstruction in a Patient with Native Mitral Valve Endocarditis having Extensive Valve Damage with Mycotic Cerebral Aneurysm**
Yun Yi Bang, Sam-Sae Oh, Tae Yun Oh, Won Jin Lee
Department of Thoracic and Cardiovascular Surgery, Kangbuk Samsung Medical Center, Sungkyunkwan University School of Medicine, Seoul, Korea
- 35 **Complete Resection of Primary Lung Cancer Invading the Left Atrium under Cardiopulmonary Bypass: Two Cases of Left Upper and Left Lower Lobectomy**
Young Woo Do, Joon Yong Cho, Deok Heon Lee
Department of Thoracic and Cardiovascular Surgery, Kyungpook National University Hospital, Kyungpook National University College of Medicine, Daegu, Korea
- 36 **Impact of Resection Margin Length on the Locoregional Recurrence after Pulmonary Metastasectomy of Colorectal Cancer**
Jae Ho Chung, Eunjoo Yi, Sung Ho Lee
Department of Thoracic and Cardiovascular Surgery, Korea University Anam Hospital, Korea University College of Medicine, Seoul, Korea
- 37 **2818 Days of Transformation Period, from Pure Ground Glass Nodule to Part Solid Nodule in Combined Breast and Thyroid Cancer Patient**
Soo Hwan Choi, Jae Kil Park
Department of Thoracic and Cardiovascular Surgery, Seoul St. Mary's Hospital, The Catholic University College of Medicine, Seoul, Korea
- 38 **Prognostic Factors Affecting Survival after Pulmonary Metastectomy from Hepatocellular Carcinoma**
Mi Hyoung Moon, Jae Kil Park, Young Kyu Moon, Kyung Soo Kim, Hyung Joo Park, Sook Whan Sung, Seok Whan Moon
Department of Thoracic and Cardiovascular Surgery, Seoul St. Mary's Hospital, The Catholic University College of Medicine, Seoul, Korea



- 39 **Consolidation/tumor Ratio on Chest Computed Tomography as a Predictor of Postoperative Nodal Upstaging in Clinical T1N0 Lung Cancer**
 Youngkyu Moon, Sook Whan Sung, Jae Kil Park, Hyung Joo Park, Seok Whan Moon
Department of Thoracic and Cardiovascular Surgery, Seoul St. Mary's Hospital, The Catholic University College of Medicine, Seoul, Korea
- 40 **Infected Giant Lung Cyst Associated with Pulmonary Tuberculosis Treated with Percutaneous Drainage and Talc Sclerotherapy: A Modified Brompton Technique**
 Se Min Ryu, Sung-Min Park, Kyung-Hak Lee, Seong-Joon Cho, Se-Ran Yang, Jeong-Ran Park, Ki Hwan Kim, Jung Eui Yun, Jin Soo Lee
Department of Thoracic and Cardiovascular Surgery, Kangwon National University Hospital, Kangwon National University College of Medicine, Gangwon-do, Korea
- 41 **Pleural Decortication for Disseminated BCG-osis in a 16 Month-old Infant with Severe Combined Immune Deficiency**
 Kyung Soo Kim, Ji Yun Lee, Jung Suk Choi, Seung Keun Yun, Seok Whan Moon
Department of Thoracic and Cardiovascular Surgery, Seoul St. Mary's Hospital, The Catholic University College of Medicine, Seoul, Korea
- 42 **Chloromethylisothiazolinone and Methylisothiazolinone Induces Lung Epithelial Cell Damage**
 Jooyeon Lee, Hanbyeol Lee, Soojin Jang, Jooyeon Se-Min Ryu, Sung-Min Park, Kyeong-Hak Lee, Sung-Joon Cho, Se-Ran Yang
Department of Thoracic and Cardiovascular Surgery, Kangwon National University Hospital, Kangwon National University College of Medicine, Gangwon-do, Korea
- 43 **The Damage of Lung Epithelial Type II Cell is Associated with Bleomycin-induced Cell Cycle Arrest**
 Soojin Jang, Hanbyeol Lee, Jooyeon Lee, Se Min Ryu, Sung-Min Park, Kyung-Hak Lee, Seong-Joon Cho, Se-Ran Yang
Department of Thoracic and Cardiovascular Surgery, Kangwon National University Hospital, Kangwon National University College of Medicine, Gangwon-do, Korea
- 44 **Surgical Management of Left Tuberculous Destroyed Lung with Bronchial Stent and Bronchopleural Fistula: A Case Report**
 Seung Hyuk Nam, Sun Kyun Ro
Department of Thoracic and Cardiovascular Surgery, Hanyang University Guri Hospital, Hanyang University College of Medicine, Gyeonggi-do, Korea
- 45 **Perioperative Risk Factors in Surgical Lung Biopsy for the Diagnosis of Interstitial Lung Disease**
 Jun Hee Lee, Eunjue Yi, Jae Ho Chung, Kwang Taik Kim, Sungho Lee
Department of Thoracic and Cardiovascular Surgery, Korea University Anam Hospital, Korea University College of Medicine, Seoul, Korea
- 46 **Two-third Chest Wall Resection of Right Thorax and Chest Wall Reconstruction using Sun-shield Technique in Recurred Myxofibrosarcoma Patient underwent Three-times Chest Wall Resections**
 Yong Ho Jeong¹, Eun Key Kim², Han Pil Lee¹, Yong-Hee Kim¹
¹Department of Thoracic & Cardiovascular Surgery, ²Department of Plastic Surgery, Asan Medical Center, Ulsan University College of Medicine, Seoul, Korea

Video Session



넷째날 2017. 11. 8(수)

장소: 크리스탈 볼룸 1+2

11:00~12:00

Video Session (1~8 연제)

좌장: 진 응, 이성수

- V 01 **Sutureless Frozen Elephant Trunk in the Elephant Trunk**
Woon Heo¹, Suk-Won Song¹, Tae-Hoon Kim¹, Shin-Young Lee¹, Min-Young Baek¹, Kyung-Jong Yoo², Bum-Koo Cho³
¹Department of Thoracic and Cardiovascular Surgery, Gangnam Severance Hospital, Yonsei University College of Medicine, Seoul, ²Department of Thoracic and Cardiovascular Surgery, Severance Hospital, Yonsei University College of Medicine, Seoul, Korea, ³The Korea Heart Foundation
- V 02 **Fluorescent-guided Thoracoscopic Lung Segmentectomy for Ground Glass Lesion: Intraoperative Localization with Electromagnetic Navigational Bronchoscopy**
Kook Nam Han, Hyun Koo Kim, Kanghoon Lee, Young Ho Choi
Department of Thoracic and Cardiovascular Surgery, Korea University Guro Hospital, Korea University College of Medicine, Seoul, Korea
- V 03 **Totally Endoscopic Mitral Valve Repair**
Jae Woong Lim, Chang Woo Choi, Keun Her, Hwa Kyun Shin
Department of Thoracic and Cardiovascular Surgery, Soonchunhyang University Hospital Bucheon, Soonchunhyang University College of Medicine, Gyeonggi-do, Korea
- V 04 **Solo Surgery for VATS Thymectomy using Thoracoscope-holding Robotic Device**
Seung Keun Yun, Seok Beom Hong, Min Namkoong, Seok Whan Moon, Kyung Soo Kim
Department of Thoracic and Cardiovascular Surgery, Seoul St. Mary's Hospital, The Catholic University College of Medicine, Seoul, Korea
- V 05 **Repair of Mitral Valve Stenosis**
Jong Bum Choi, Tae Yun Kim, Jong Hun Kim, Ja Hong Kuh
Department of Thoracic and Cardiovascular Surgery, Chonbuk National University Hospital, Chonbuk National University College of Medicine, Jeollabuk-do, Korea
- V 06 **Laparoscopic Surgery for Epiphrenic Esophageal Diverticulum**
Yeon Soo Kim¹, Woo Yong Lee²
¹Department of Thoracic and Cardiovascular Surgery, ²Department of General Surgery, Inje University Ilsan Paik Hospital, Inje University College of Medicine, Gyeonggi-do, Korea
- V 07 **Modified Bio-bentall Procedure: The French Cuff Technique**
Sang-Ho Cho¹, Dae Hyun Kim¹, Young Tae Kwak¹, Joo-Chul Park¹, Hyo Chul Yoon², Soo-Cheol Kim², Bum-Sik Kim²
¹Department of Thoracic and Cardiovascular Surgery, Kyung Hee University Hospital at Gangdong, Kyung Hee University College of Medicine, Seoul, ²Department of Thoracic and Cardiovascular Surgery, Kyung Hee University Hospital, Kyung Hee University College of Medicine, Seoul, Korea
- V 08 **Sutureless Aortic Valve Replacement as an Affordable Alternative Option for a High-risk Patient with Previous Coronary Artery Bypass Grafting**
Jae Suk Yoo
Department of Thoracic and Cardiovascular Surgery, Sejong General Hospital, Gyeonggi-do, Korea

대한흉부심장혈관외과학회

제3회 초음파연수강좌

프 로 그 램



일시: 2017. 11. 6(월) 13:00~17:35

장소: 루비룸

13:00~15:00	Organ-oriented Ultrasonography	좌장: 나국주(전남대병원)
13:00~13:30	Principles of Ultrasonography	김태식(한림병원)
13:30~14:00	US Scanning Strategy for Vascular and Endovascular Procedures	김우식(국립중앙의료원)
14:00~14:30	Echocardiography: From basic to Bedside	김재범(계명대병원)
14:30~15:00	Ultrasound-guided Endovenous Treatment	홍기표(일산병원)
15:00~15:30	<i>Coffee-break</i>	
15:30~17:35	Problem-oriented Ultrasonography	좌장: 정진용(가톨릭대인천성모병원)
15:30~15:55	Lung Ultrasonography: How Can We Watch the Air by Ultrasound?	이현주(서울대병원)
15:55~16:20	Assessing Fluid Responsiveness with Ultrasonography	김동중(분당서울대병원)
16:20~16:45	POC US-guided ECMO Cannulation	이준완(충남대병원)
16:45~17:10	Bedside Thoracic Procedures with Ultrasound	김도완(전남대병원)
17:10~17:35	Failed Ventilator Weaning: Practical Checkpoints from US	임주영(서울아산병원)

대한흉부심장혈관외과학회
제3회 초음파연수강좌 핸드온
프로그램



일시: 2017. 11. 6(월) 10:00 ~ 17:00

장소: 제이드룸

Transthoracic Echocardiography (I)

김태식(한림병원), 이준완(충남대병원), 김재범(계명대병원)

Transthoracic Echocardiography (II)

나국주(전남대병원), 정진용(가톨릭대인천성모병원), 김태식(한림병원)

Lung & Pleura Ultrasonography

임주영(서울아산병원), 김도완(전남대병원), 이현주(서울대병원)

Vascular Ultrasonography

홍기표(일산병원), 김동중(분당서울대병원), 김우식(국립중앙의료원)

대한흉부심장혈관외과학회 체외순환사협회 추계학술대회 프 로 그 램



일시: 2017. 11. 7(화) 10:00~12:00

장소: 사파이어룸 (호텔 6층)

09:00~10:00 등 록

10:00~10:10 개 회 사
격 려 사

협회장: 백인창

이사장: 심성보(대한흉부심장혈관외과학회)

(*시간은 발표 후 5분간 토의시간 포함)

좌장: 박희곤(양산부산대학교병원)

10:10~10:40 성인심장환자에서의 델니도 심정지액

황호영(서울대학교병원 흉부외과)

10:40~10:55 QUANTUM: the Future of Extracorporeal Technology

윤영호(리파메드(유)부장)

10:55~11:25 How became to a Perfusionist in Taiwan?

Perfusionist Chou Yueh-Ting (Veterans General Hospital, Taipei, Taiwan)

11:25~12:00 정기총회
폐 회 사

총 무
협회장

대한흉부심장혈관외과학회
제7차 흉부외과 지도전문의 교육
프 로 그 램



일시: 2017. 11. 7(화)

장소: 루비룸

시 간	교육내용	연 자
09:00~09:20	전공의 연차별 수련 목표 및 내용	정인석(전남대학교병원)
09:20~09:40	전문의 자격시험 및 취득 요건	최창휴(가천대학교 길병원)
09:40~10:00	전공의 수련 프로그램의 효과적인 평가방법	이석재(제주대학교병원)

대한흉부심장혈관외과학회
여의사회
프 로 그 램



일시: 2017. 11. 7(화) 12:30~13:30

장소: 루비룸

12:30~13:30 여성성과 리더쉽

곽영숙(제주대학교 정신과)